

BOCCHI[®]

FOR EVERY SHADE OF YOU



BATHROOM COLLECTION



The background of the entire page is a high-resolution, close-up photograph of water ripples. The light reflects off the crests and troughs of the waves, creating a complex, organic pattern of light and dark grey tones. This texture fills the entire frame, providing a serene and naturalistic backdrop for the text.

BOCCHI®

BATHROOM COLLECTION



With over 70 years of experience, BOCCHI is a leading brand in the kitchen and bathroom products industry. Since our establishment in 1950, the values of BOCCHI have never changed: creative and innovative excellence at every level, as well as care for people and for the environment.

Our mission has always been to offer our partners innovative, high-quality and creative solutions in products and services to provide a unique and valued experience.

Today, BOCCHI harmoniously brings together tradition and design, and proudly stands for quality, durability and care.

Using sustainable processes and practices, we make it our priority to care for the environment through every step of production. Our products are built on tradition, designed for your busy life, and with the utmost care for tomorrow.

BOCCHI[®]
FOR EVERY SHADE OF YOU



INDEX

08 ABOUT BOCCHI

- 9 Fine Fireclay
- 10 BOCCHI Design
- 12 Exclusive BOCCHI Colors
- 14 BOCCHI Technologies
- 16 BOCCHI ECO

18 BATHROOM COLLECTIONS

- 18 Etna
- 26 Fenice
- 34 Firenze
- 40 Lavita
- 44 Milano
- 58 Parma
- 66 Ravenna
- 74 Scala
- 78 Scala Arch
- 86 Sottile
- 100 Taormina
- 106 Venezia
- 110 Vettore

114 COMFORT & CARE

118 WARRANTY & CARE



FINE FIRECLAY

BOCCHI brings back the ultimate material to your home. Fireclay, a 100% natural and recyclable material, used by craftsmen for centuries to create timeless fixtures, has now returned to our bathrooms.

Due to the specialized manufacturing process, which includes firing in kilns up to 2000 degrees Fahrenheit, fireclay becomes one of the most durable materials used in today's bathroom fixtures. Their specialized glaze coating that is fused with the fireclay body during firing gives fireclay sinks a non-porous, uniform surface which will not scratch, rust or stain over time.

BOCCHI Fireclay Bathroom Products allow homeowners to compliment other furnishings and incorporate many different themes to showcase their creativity.

With 12 designer colors to choose from including metallic glaze finishes, and multiple styles and sizes, each product can be installed in multiple ways that allow you truly customize your style... define your world with BOCCHI bathroom products.



BOCCHI Clean+

Easier to clean & stays clean longer



Super Smooth Surface

19 times smoother than ordinary Fireclay surface



Food-Safe

Safe for toothpastes and medicines



Stain Resistant

Easily remove stains from makeup and more



Impact-Resistant

Extremely durable and scratch resistant



Heat Proof

Extreme heat from styling tools or almost anything



UV-Protected

Won't fade or discolor



DESIGN

The idea of design now goes beyond mere objects and products and turns into a holistic experience in our age.

Our priority is to introduce differentiated products that have stories. Stories driven by the idea of design, to the process all the way from initial design concepts through the end user.

BOCCHI is committed to combining its modern and traditional human-oriented design approach with high technology to offer innovative solutions. It's a hallmark to our company's original motto of "il bagno per tutti" or "a bathroom for all."

Each product takes a journey from soil to ceramic... along the way BOCCHI remains a leader in its awareness for responsibility for nature and society. Each product is designed and built with care, and meant to last.

EXCLUSIVE BOCCHI COLORS

Color choices in the home create focal points, convey emotions and reflect our personal style.

Now BOCCHI gives you the opportunity to carry all these colors into your bathroom. You can create unique color stories in your home that balance the natural focal point created by your bathroom fixtures with the harmony created by your other accessories and finishes.

What color will you choose?





White
Fireclay (001)



Matte White
Fireclay (002)



Matte Black
Fireclay (004)



Black
Fireclay (005)



Matte Gray
Fireclay (006)



Sapphire Blue
Fireclay (010)

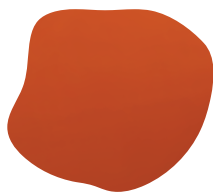

Orange
Fireclay (012)



Biscuit
Fireclay (014)



Matte Ice Blue
Fireclay (029)

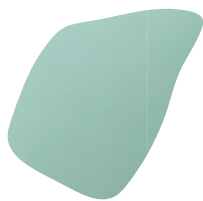

Matte Mint Green
Fireclay (033)

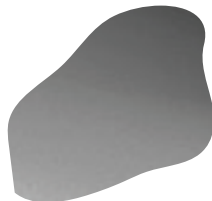

Platinum
Fireclay (401)



Matte Gold
Fireclay (403)



SUPER SMOOTH SURFACE

Super Smooth Surface technology has been developed to minimize lime remains, undesirable dirt and bacteria on ceramic surfaces and make cleaning easier. This technology is the result of many years of research.

Super Smooth Surface is 19 times smoother and has less roughness than regularly glazed surfaces.

Test results show that super smooth technology provides a surface that has a higher quality than regular porcelain surfaces. Therefore, the Super Smooth Surface requires much less water to clean and is more hygienic.

19X SMOOTHER, 19X EASIER



CLEAN+ TECHNOLOGY

Another innovative enhancement from BOCCHI is the Clean+ Technology. This technology helps you keep your bathroom fixtures always brilliant, clean, shiny and new.

Clean+ Technology decreases roughness so the contact angle of the ceramic surface can create a hydrophobic effect, which helps to prevent lime remains and undesirable dirt build up.

A smooth wipe and a mild cleaning would be sufficient to maintain the spark of your fireclay.

developed by
BOCCHI®



BOCCHI ECO

BOCCHI takes great pride in producing our products with SUSTAINABILITY in mind. Our production processes and packaging are designed to minimize waste and reduce our carbon footprint. We only use sustainably sourced materials.

We believe that our customers should be able to enjoy high-quality products while knowing that they are doing their part for the environment.

BOCCHI[®]
FOR EVERY SHADE OF YOU



ETNA



1114-XXX-0125
Vessel Sink

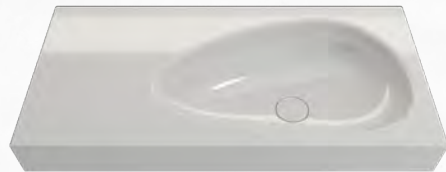

1115-XXX-0125
Wall-Mounted Sink



1075-XXX-0125
Monoblock Pedestal Sink
with Integrated Pedestal



1162-XXX-0125
Monoblock Vessel Sink



7712-XXXX-1162
Wooden Bench



1114-403-0125
Matte Gold

ETNA

VESSEL SINK
1114-XXX-0125

Features

- Fine Fireclay construction
- Includes color-matched pop-up drain cover and assembly

Dimensions

- 23" x 14.5" x 4"

Standard Color



White
(001)

Premium Colors



Matte White
(002)



Matte Black
(004)



Black
(005)



Matte Gray
(006)



Sapphire Blue
(010)



Orange
(012)



Matte Ice Blue
(029)



Matte Mint Green
(033)

Special Color



Biscuit
(014)

Metallic Colors



Platinum
(401)



Matte Gold
(403)

Technical Drawing

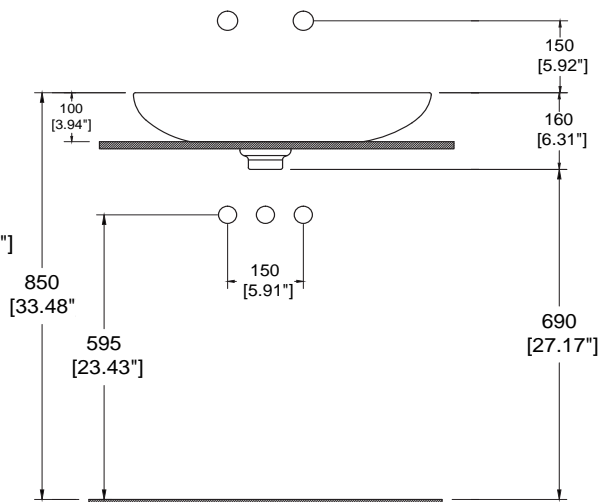
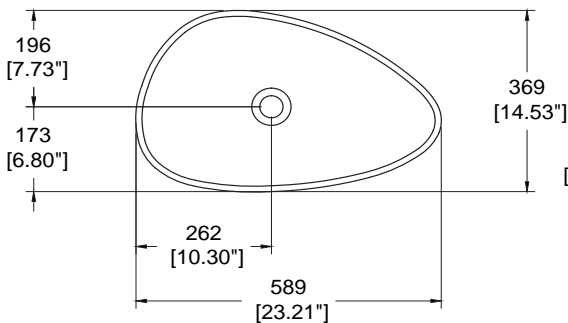

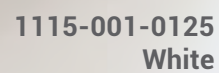

WALL-MOUNTED /
VESSEL SINK
1115-XXX-0125

- Fine Fireclay construction
- May be wall-mounted or used as a vessel
- Includes color-matched pop-up drain cover and assembly
- Includes mounting hardware

- 35.5" x 18" x 4"

White
(001)

Matte
White
(002)



Matte
Black
(004)



Black
(005)



Matte
Gray
(006)



Sapphire
Blue
(010)



Orange
(012)



Matte
Ice Blue
(029)



Matte
Mint
Green
(033)

Biscuit
(014)

Platinum
(401)

Matte
Gold
(403)

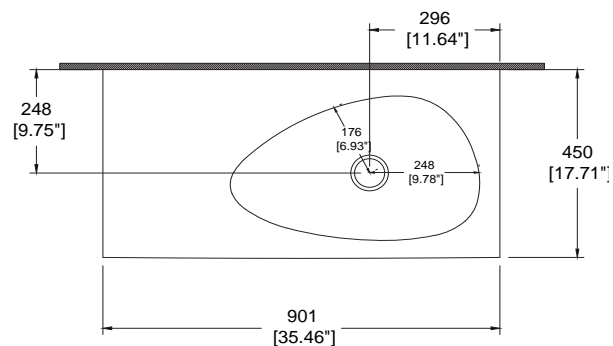
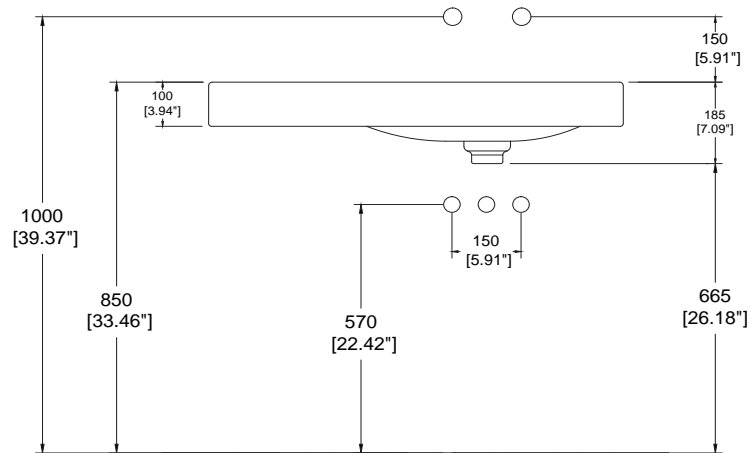



1075-010-0125
Sapphire Blue



ETNA

MONOBLOCK
PEDESTAL SINK
1075-XXX-0125

Features

- Fine Fireclay construction
- Includes color-matched pop-up drain cover and assembly
- Requires either a floor-standing or wall-mounted faucet

Dimensions

- 23" x 17" x 34"

Standard Color



White
(001)

Premium Colors



Matte
White
(002)



Matte
Black
(004)



Black
(005)



Sapphire
Blue
(010)

Technical Drawing

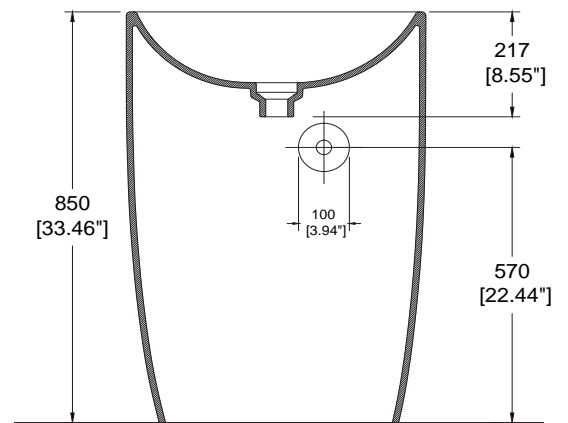
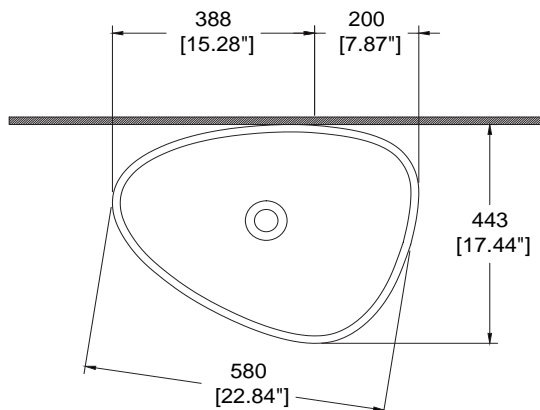



1162-001-0125
White



ETNA

MONOBLOCK
VESSEL SINK
1162-XXX-0125

Features

- Fine Fireclay construction
- Includes color-matched pop-up drain cover and assembly
- Requires wall-mounted faucet
- May be used as a vessel and compatible with the 7712-XXX-1162 wooden bench

Dimensions

• 23" x 17" x 16"

Standard Color



White
(001)

Premium Colors



Matte White
(002)



Matte Black
(004)



Black
(005)



Matte Gray
(006)



Sapphire Blue
(010)



Orange
(012)



Matte Ice Blue
(029)



Matte Mint Green
(033)

Special Color



Biscuit
(014)

Compatible Products



Wooden Bench
7712-1710-1162 Walnut
7712-1610-1162 Matte Gray

Technical Drawing

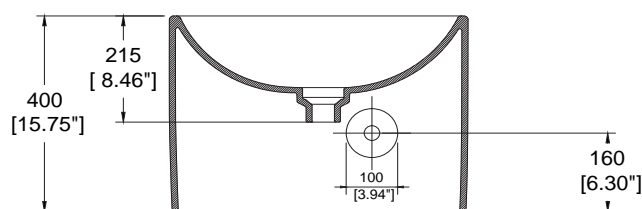
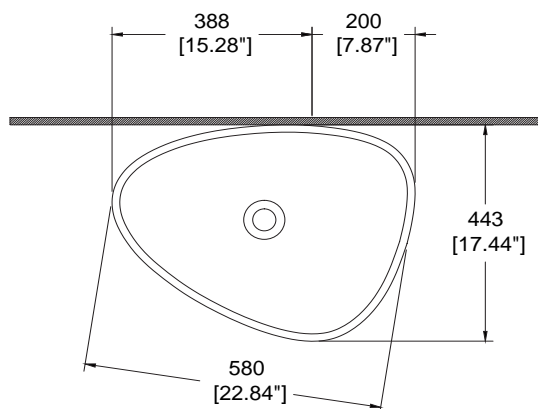



1162-001-0125
White top
7712-1710-1162
Walnut base



ETNA

WOODEN BENCH

7712-1710-1162

(Walnut)

7712-1610-1162

(Matte Gray)

**Standard
Color**



Walnut
(1710)



Matte Gray
(1610)

Features

- Solid wood decorative bench
- Water and moisture resistant acrylic lacquer
- Sink sold separately

Dimensions

- 47.25" x 19.60" x 16.15"



Compatible Products

Monoblock Vessel Sink

1162-XXX-0125 (sold separately)

Technical Drawing

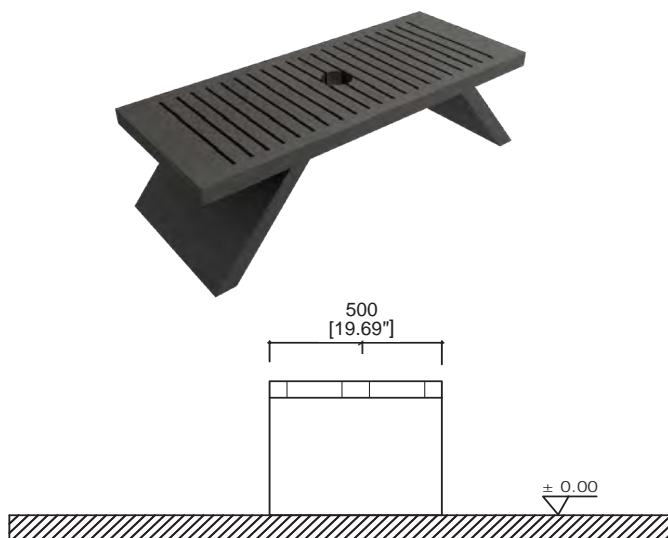
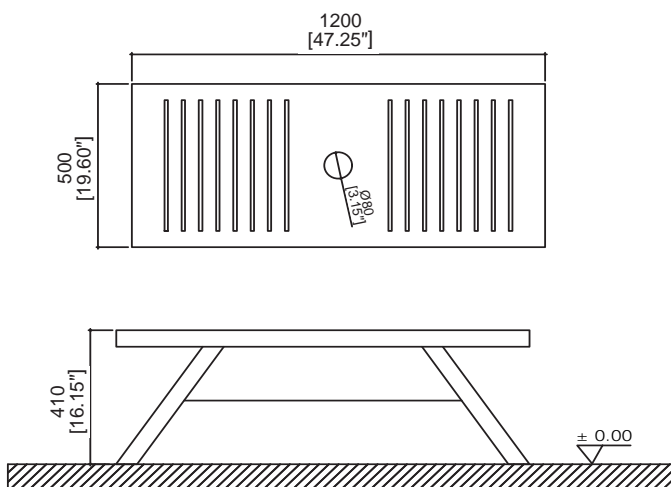





FENICE



1489-XXX-0126
Vessel



1490-XXX-0126
Counter Sink
(May be wall-mounted or used with
select bases)



7008-XXXX-1490
Wall-hung Sink Cabinet
(Compatible with
1490-XXX-0126 sinks)



1489-029-0126
Matte Ice Blue



Features

- Fine Fireclay construction
- Single hole faucet
- Without overflow hole

Dimensions

- 21.75"x17.75"x5.6"

FENICE

VESSEL LAVATORY

1489-XXX-0126

Standard Color



White
(001)

Premium Colors



Matte White
(002)



Matte Black
(004)



Black
(005)



Matte Gray
(006)



Sapphire Blue
(010)



Orange
(012)



Matte Ice Blue
(029)



Matte Mint Green
(033)

Special Color



Biscuit
(014)

Technical Drawing

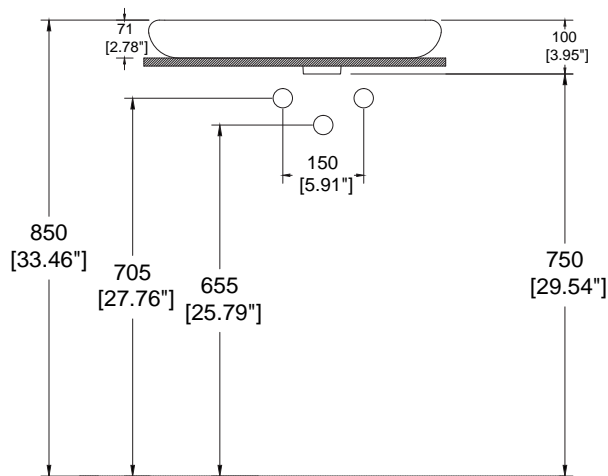
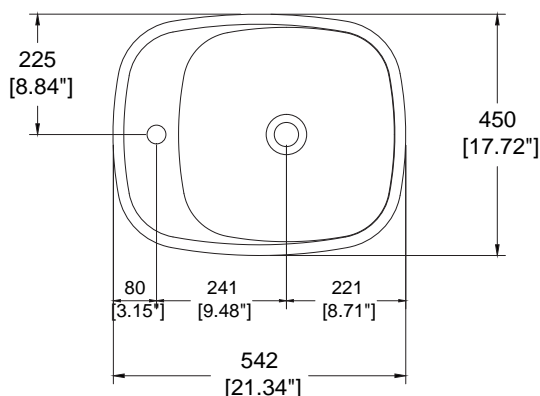





1490-001-0126
with Console Leg



FENICE

WALL-MOUNTED /
VESSEL SINK
1490-XXX-0126

Features

- Fine Fireclay construction
- Single hole faucet, without overflow
- May be wall-mounted, used as a vessel, with the 7008-XXXX-1490 cabinet base (see next page), or with metal console legs
- Includes mounting hardware

Dimensions

- 35.5" x 18" x 5.6"



ADA
Compliant

Standard Color



White
(001)

Premium Colors



Matte
White
(002)



Matte
Black
(004)



Black
(005)



Matte
Gray
(006)



Sapphire
Blue
(010)



Orange
(012)



Matte
Ice Blue
(029)



Matte
Mint
Green
(033)

Special Color



Biscuit
(014)

Technical Drawing

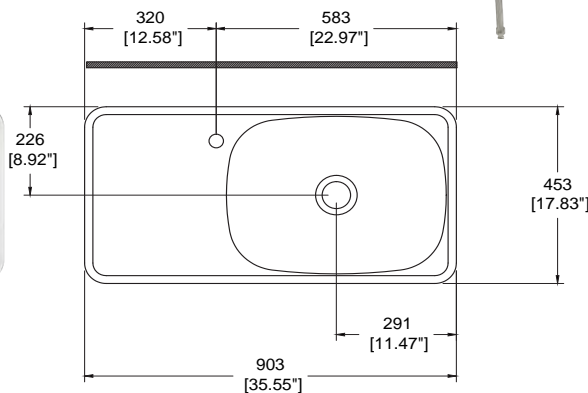

Compatible Products

Metallic Console Leg

- 3930 0001 S Brushed Nickel
- 3930 0001 F Matte Black
- 3930 0001 G Matte Gold

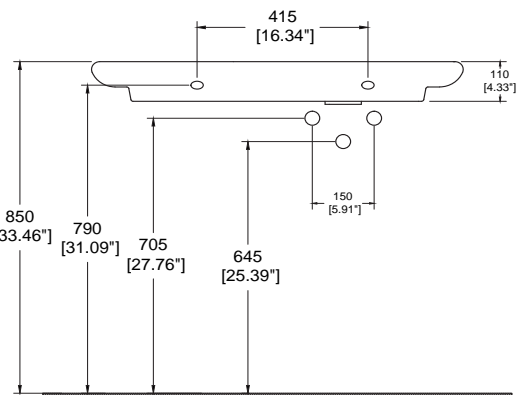



1490-001-0126 top
7008-0157-1490 base
in White



FENICE

WALL-HUNG
CABINET BASE
7008-0157-1490

(White)

7008-2058-1490

(Anthracite)

(Compatible with 1490-XXX-XXXX
sinks only / sink sold separately)

Features

- Wall-hung
- Soft-close drawer glides
- Features ultra-durable Thermo-foil

Dimensions

- 33" x 18.5" x 17.25"

Cabinet Colors



White
(0157)



Anthracite
(2058)

Technical Drawing

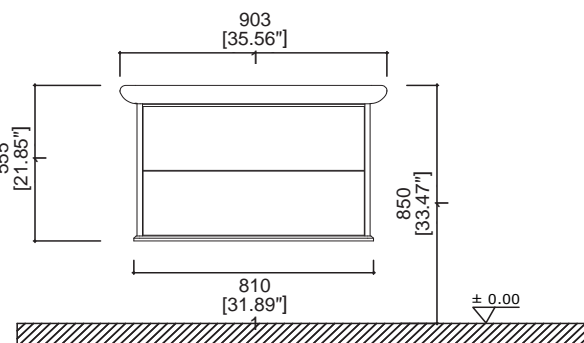
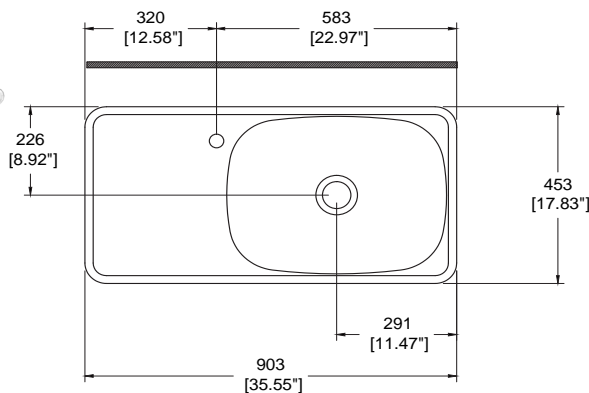







FIRENZE



1074-XXX-0126

Vessel



1304-XXX-0129

Wall-hung Toilet Bowl



1074-006-0126
Matte Gray

FIRENZE

VESSEL SINK
1074-XXX-0126

Features

- Fine Fireclay construction
- Single hole faucet
- Without overflow hole

Dimensions

- 20" x 16.5" x 5.5"

Standard Color



White
(001)

Premium Colors



Matte White
(002)



Matte Black
(004)



Black
(005)



Matte Gray
(006)



Sapphire Blue
(010)



Orange
(012)



Matte Ice Blue
(029)



Matte Mint Green
(033)

Special Color



Biscuit
(014)

Technical Drawing

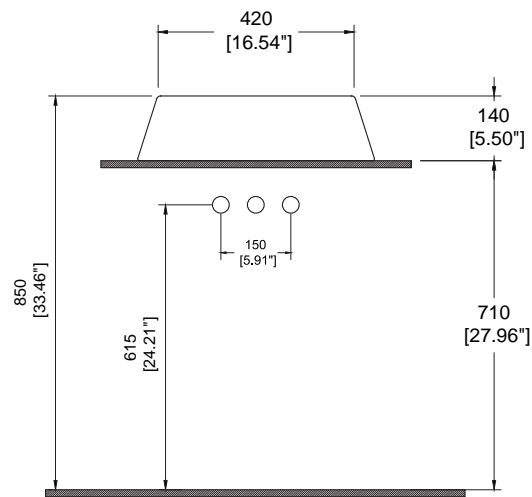
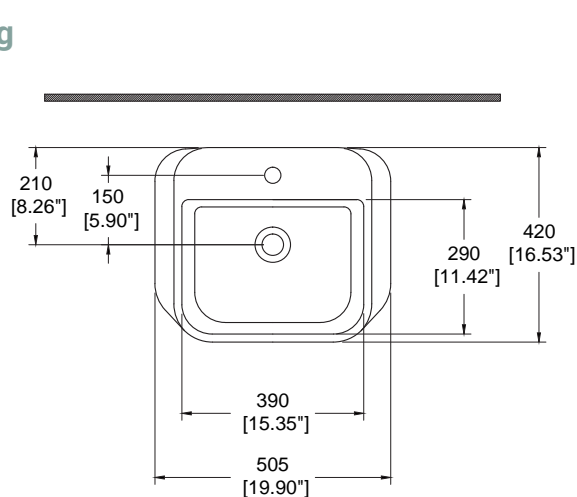



Wall-hung Toilet Bowl
1304-001-0129

FIRENZE

WALL-HUNG TOILET BOWL

1304-XXX-0129

(Compatible with A0332-XXX
Toilet Seat / Sold separately)

Features

- Vitreous China construction
- Wall-hung toilet bowl
- Compatible with A0332-XXX soft-close toilet seat (sold separately)
- In-wall tank and button control sold separately/compatible with standard in-wall tanks

Dimensions

- 13.5" x 21"
(height adjustable)

Standard Color



White
(001)

Premium Colors



Matte
White
(002)



Matte
Black
(004)



Black
(005)

Special Color



Biscuit
(014)

Technical Drawing

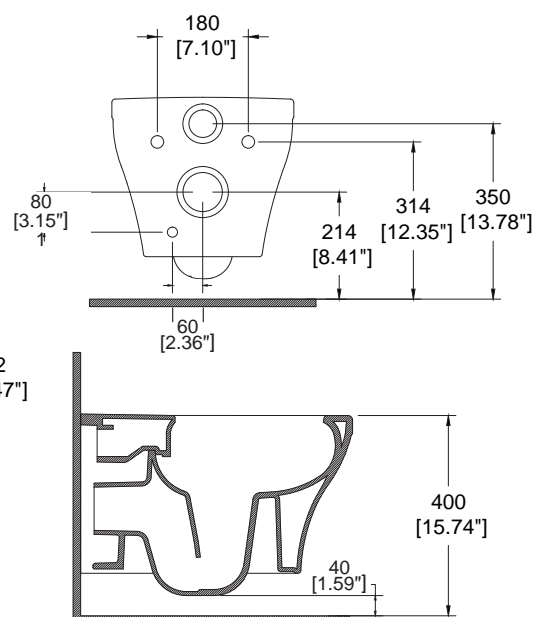
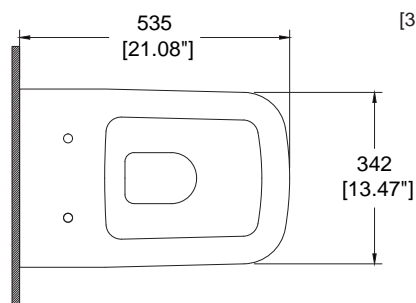







LAVITA



1168-XXX-0127

Console Sink
(May be wall-mounted or used with
select leg set)



1169-XXX-0320

Console Sink
(Fireclay Leg Set)





1168-001-0127



LAVITA

CONSOLE SINK

1168-XXX-0127

Features

- Fine Fireclay construction
- 8" faucet setting, with overflow
- May be used with 1169-XXX-0320 fireclay legs OR Metallic Console Legs 3930 0001 X
- Includes mounting hardware

Dimensions

• 40" x 19.75" x 33.5"



ADA
Compliant

Standard Color



White
(001)

Special Color



Biscuit
(014)

Premium Colors



Matte White
(002)



Matte Black
(004)



Black
(005)

Technical Drawing



Compatible Products

Metallic Console Leg

3930 0001 S Brushed Nickel
3930 0001 F Matte Black
3930 0001 G Matte Gold

Fireclay Leg Set

1169-XXX-0320

Available in: White (001), Matte White (002), Black (005), Matte Black (004), Biscuit (014), Matte Gold (403), Platinum (401)

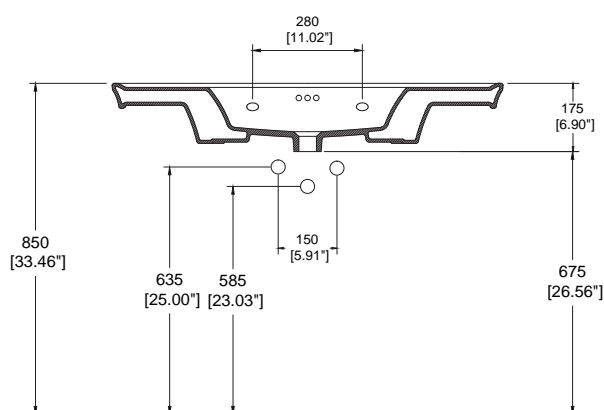
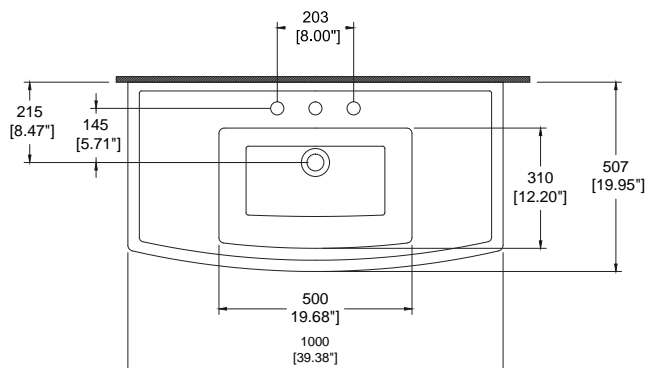



MILANO



1394-XXX-0132

Counter Sink (single or 8")
(May be wall-mounted OR used with
metallic console legs)



1393-XXX-0132

Counter Sink
(May be wall-mounted OR used with
metallic console legs)



1378-XXX-XXXX

Counter Sink (single or 8")
(May be wall-mounted OR used with
metallic console legs)



1377-XXX-XXXX

Counter Sink (single or 8")
(May be wall-mounted OR used with
metallic console legs)



1376-XXX-XXXX

Counter Sink (single or 8")
(May be wall-mounted OR used with
metallic console legs)



1392-XXX-0126

Corner Sink
(Wall-mounted)



1418-XXX-0126

Counter Sink
(May be wall-mounted or used
with matching furniture base)



1419-XXX-0126

Counter Sink
(May be wall-mounted or used
with matching furniture base)

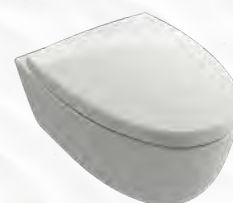

1632-XXX-0129

Wall-hung Toilet Bowl
(Compatible with standard
in-wall tanks/sold separately)



7020-XXXX-1418

Wall-hung Cabinet Base
(Compatible with 1418-XXX-0126 sinks)



7020-XXXX-1419

Wall-hung Cabinet Base
(Compatible with 1419-XXX-0126 sinks)



1394-010-0127
Sapphire Blue



MILANO

COUNTER SINK

1394-XXX-0126

(Single hole)

1394-XXX-0127

(3-hole)

**Standard
Color**



White
(001)

**Special
Color**



Biscuit
(014)

**Premium
Colors**



Matte
White
(002)



Matte
Black
(004)



Black
(005)



Matte
Gray
(006)



Sapphire
Blue
(010)



Orange
(012)



Matte
Ice Blue
(029)



Matte
Mint
Green
(033)

Features

- Fine Fireclay construction
- Single-hole OR 3-hole faucet setting
- With overflow hole

(May be wall-mounted OR used with metal console legs)

Dimensions

- 47.5" x 18.5" x 4.75"



ADA
Compliant

Technical Drawing

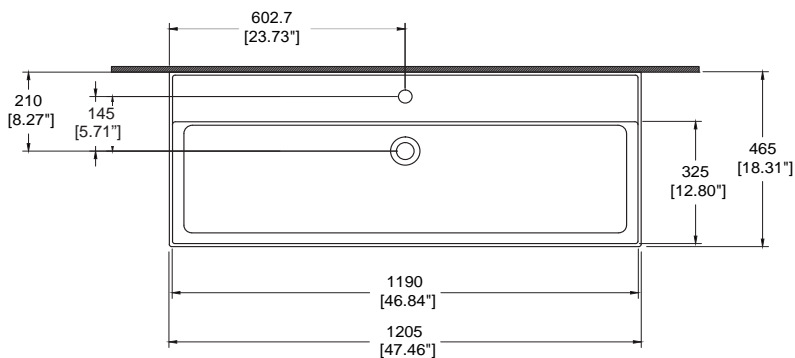

Compatible Products



Metallic Console Leg

3930 0001 S Brushed Nickel

3930 0001 F Matte Black

3930 0001 G Matte Gold

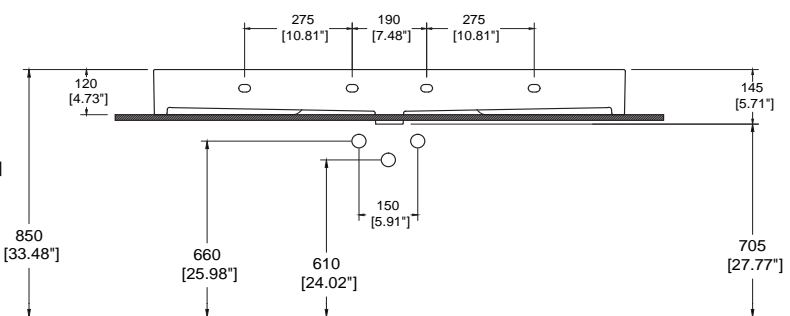



1393-002-0132
Matte White

MILANO

COUNTER SINK

1393-XXX-0132

Features

- Fine Fireclay construction
- Double Basin
- Dual single-hole faucet setting
- With overflow hole

(May be wall-mounted OR
used with metal console legs)

Dimensions

• 47.5" x 18.5" x 4.75"



ADA
Compliant

Standard Color



White
(001)

Special Color



Biscuit
(014)

Premium Colors



Matte
White
(002)



Matte
Black
(004)



Black
(005)



Matte
Gray
(006)



Sapphire
Blue
(010)



Orange
(012)



Matte
Ice Blue
(029)



Matte
Mint
Green
(033)

Technical Drawing

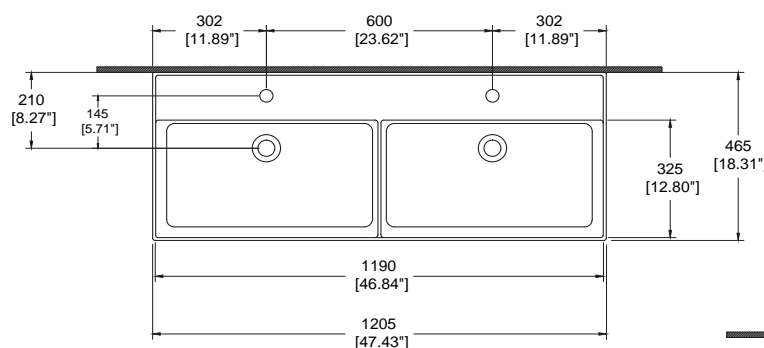
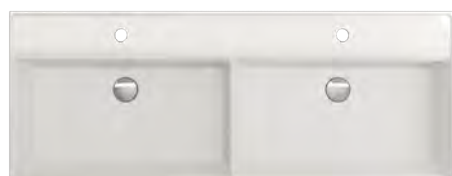

Compatible Products

Metallic Console Leg

3930 0001 S Brushed Nickel

3930 0001 F Matte Black

3930 0001 G Matte Gold

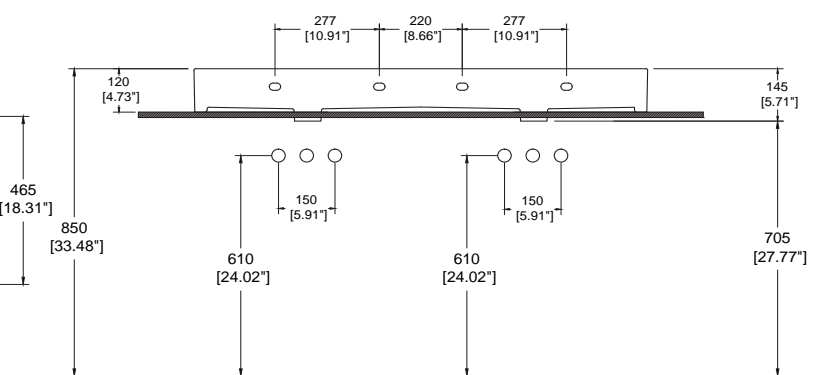



1377-002-0127
Matte White

MILANO

COUNTER SINK

1377-XXX-0126

(Single hole)

1377-XXX-0127

(3-hole)

Features

- Fine Fireclay construction
- Single-hole OR 3-hole faucet setting
- With overflow hole

(May be wall-mounted OR used with metal console legs)

Dimensions

- 32" x 18.35" x 4.75"



ADA
Compliant

Standard Color



White
(001)

Special Color



Biscuit
(014)

Premium Colors



Matte White
(002)



Matte Black
(004)



Black
(005)



Matte Gray
(006)



Sapphire Blue
(010)



Orange
(012)



Matte Ice Blue
(029)



Matte Mint Green
(033)

Technical Drawing

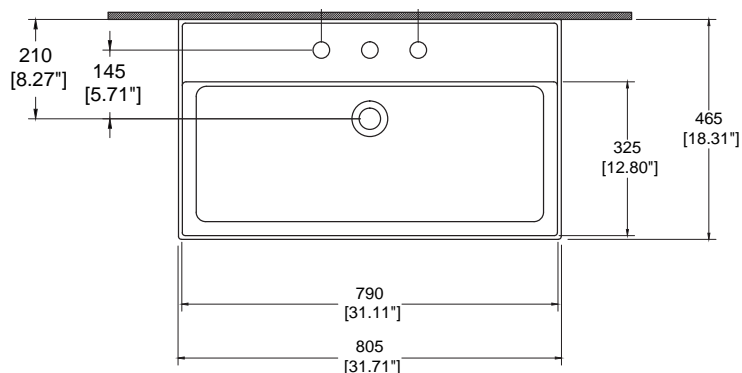

Compatible Products



Metallic Console Leg
 3930 0001 S Brushed Nickel
 3930 0001 F Matte Black
 3930 0001 G Matte Gold

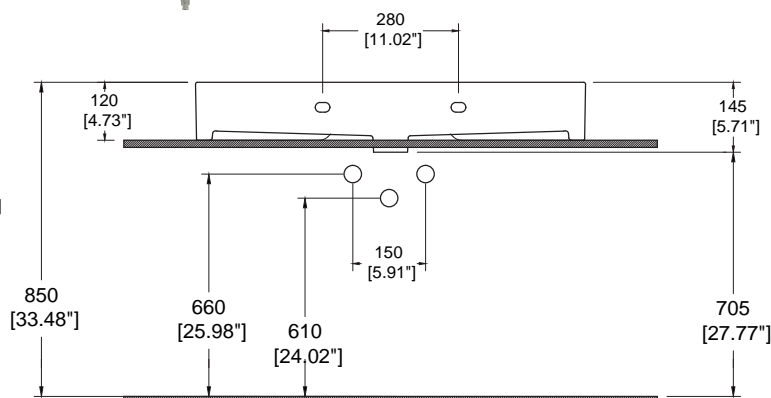



1376-001-0126
White

MILANO

COUNTER SINK

1376-XXX-0126

(Single hole)

1376-XXX-0127

(3-hole)

Features

- Fine Fireclay construction
- Single-hole OR 3-hole faucet setting
- With overflow hole

(May be wall-mounted OR used with metal console legs)

Dimensions

- 24" x 18.35" x 4.75"



ADA
Compliant

Standard Color



White
(001)

Special Color



Biscuit
(014)

Premium Colors



Matte White
(002)



Matte Black
(004)



Black
(005)



Matte Gray
(006)



Sapphire Blue
(010)



Orange
(012)



Matte Ice Blue
(029)



Matte Mint Green
(033)

Technical Drawing

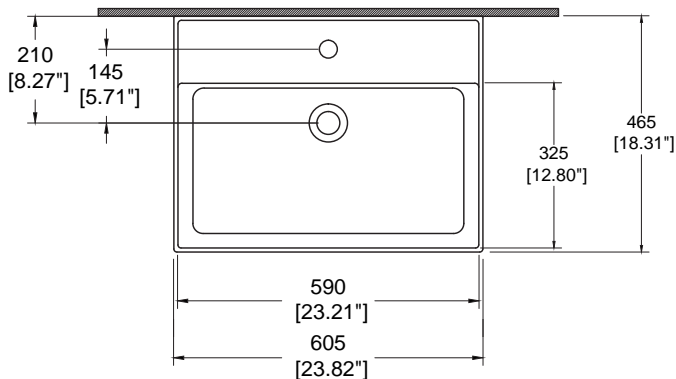

Compatible Products

Metallic Console Leg

3930 0001 S Brushed Nickel

3930 0001 F Matte Black

3930 0001 G Matte Gold

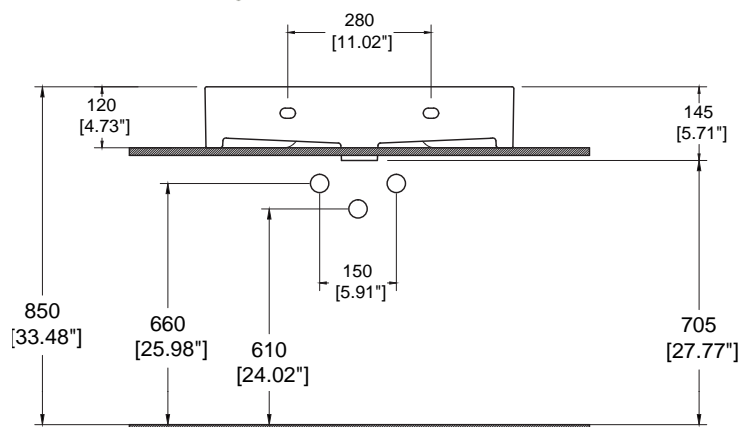



1392-004-0126
Matte Black

MILANO

CORNER SINK

WALL-MOUNTED

1392-XXX-0126

Features

- Fine Fireclay construction
- Single-hole faucet setting
- Without overflow hole
- Wall-mounting hardware included

Dimensions

- 12" x 4" tall
- 12.5" projection from wall corner to lip of sink

Standard Color



White
(001)

Special Color



Biscuit
(014)

Premium Colors



Matte White
(002)



Matte Black
(004)



Black
(005)



Matte Gray
(006)



Sapphire Blue
(010)



Orange
(012)



Matte Ice Blue
(029)



Matte Mint Green
(033)

Technical Drawing

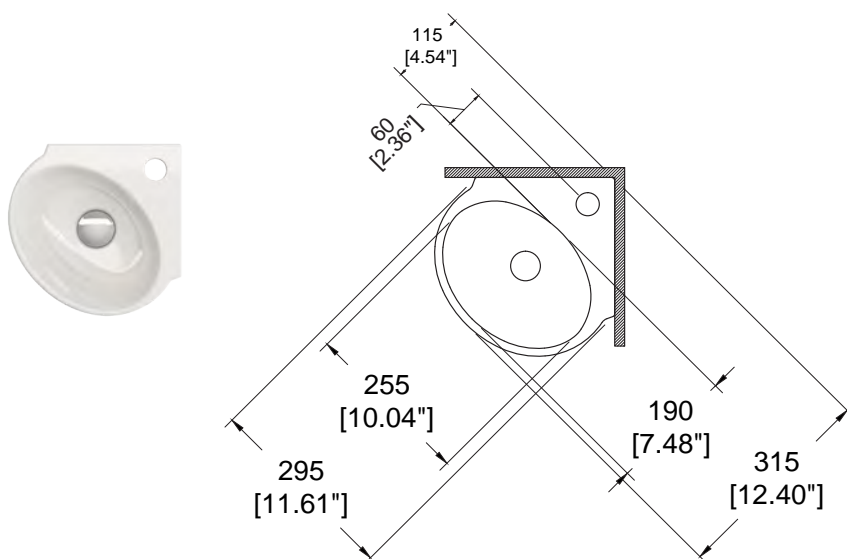



1418-012-0126
Orange



MILANO

COUNTER SINK

1418-XXX-0126

(May be wall-mounted)

Features

- Fine Fireclay construction
- Single-hole faucet setting on left-side-facing, without overflow hole
- Wall-mounting hardware included
- Compatible with 7020-XXXX-1418 cabinet base

Dimensions

- 14.75" x 9" x 4.5"

Standard Color



White
(001)

Special Color



Biscuit
(014)

Premium Colors



Matte White
(002)



Matte Black
(004)



Black
(005)



Matte Gray
(006)



Sapphire Blue
(010)



Orange
(012)



Matte Ice Blue
(029)



Matte Mint Green
(033)

Technical Drawing

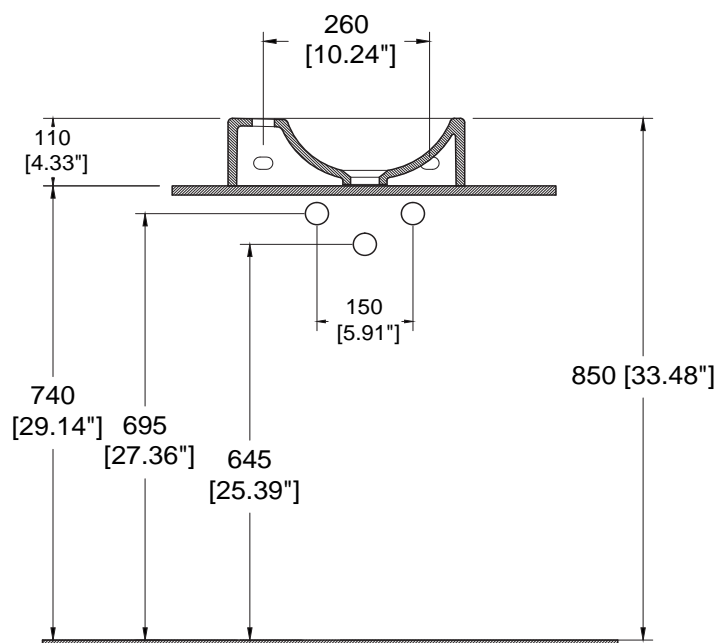
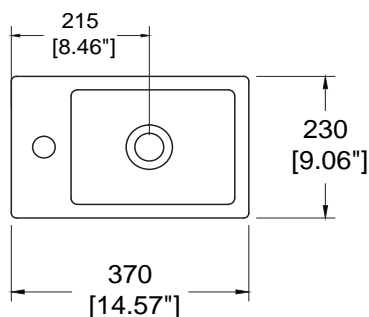



1419-001-0126
White

MILANO

COUNTER SINK

1419-XXX-0126

(May be wall-mounted)

Features

- Fine Fireclay construction
- Single-hole faucet setting on right-side-facing, without overflow hole
- Wall-mounting hardware included
- Compatible with 7020-XXXX-1419 cabinet base

Dimensions

- 14.75" x 9" x 4.5"

Standard Color



White
(001)

Special Color



Biscuit
(014)

Premium Colors



Matte White
(002)



Matte Black
(004)



Black
(005)



Matte Gray
(006)



Sapphire Blue
(010)



Orange
(012)



Matte Ice Blue
(029)



Matte Mint Green
(033)

Technical Drawing

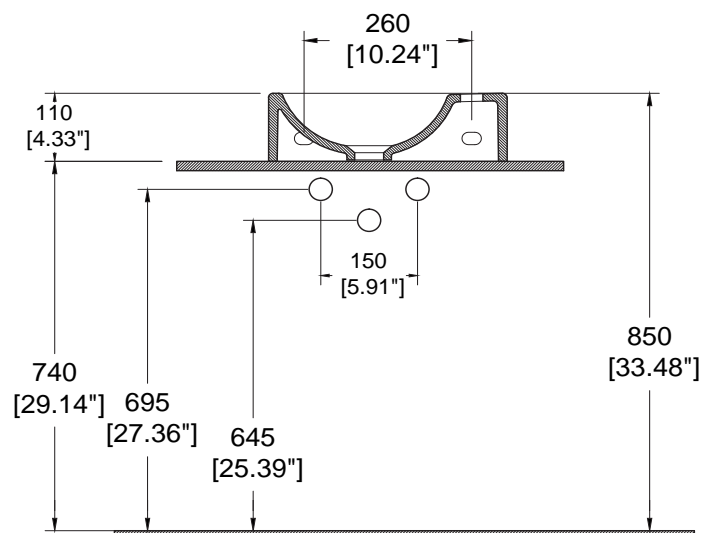
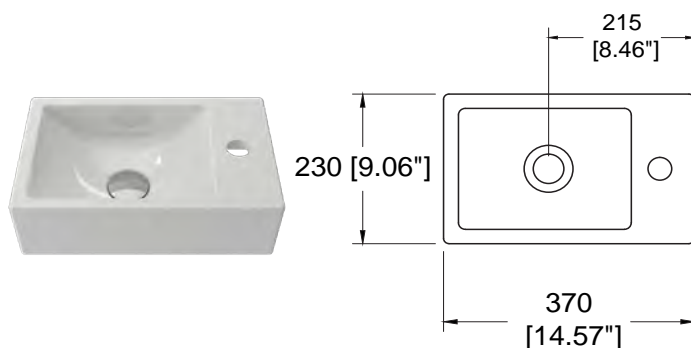



1418-001-0126 top
7020-2009-1418 base
in Anthracite



MILANO

WALL-HUNG
CABINET BASE

7020-0101-1418
(White)

7020-2009-1418
(Anthracite)

(Compatible with
1418-XXX-XXXX sinks only /
sink sold separately)

Features

- Wall-hung
- Soft-close door, hinged on left
- Features ultra-durable thermo-foil

*1418 sink is available in 10 colors.

Dimensions

- 14.5" x 9" x 17.75"

Cabinet Colors



White
(0101)



Anthracite
(2009)

Technical Drawing

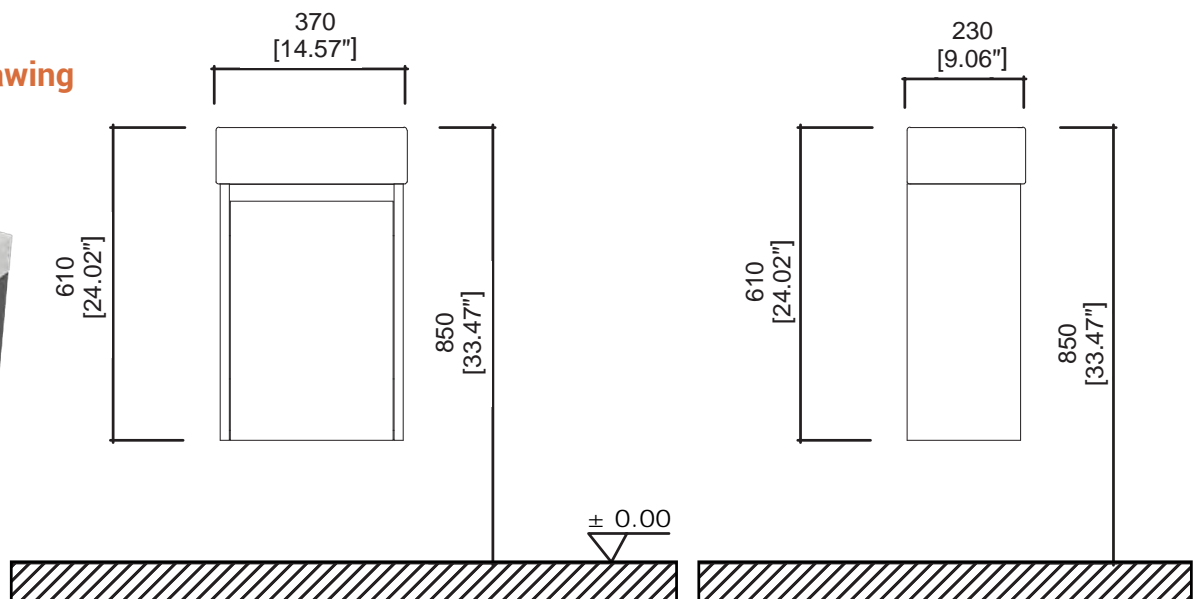



1419-033-0126 top
7020-0101-1419 base in White



MILANO

WALL-HUNG
CABINET BASE
7020-0101-1419
(White)

7020-2009-1419
(Anthracite)
(Compatible with
1419-XXX-0126 sinks only /
sink sold separately)

Features

- Wall-hung
- Soft-close door, hinged on right
- Features ultra-durable thermo-foil

*1419 sink is available in 10 colors.

Dimensions

- 14.5" x 9" x 17.75"

Cabinet Colors



White
(0101)



Anthracite
(2009)

Technical Drawing

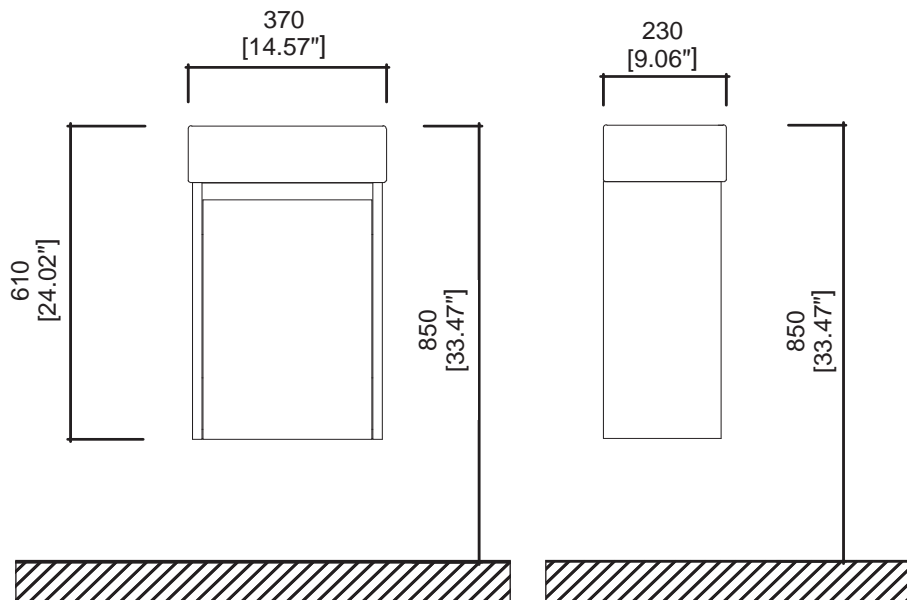



1632-004-0129
Matte Black



MILANO

WALL-HUNG
TOILET BOWL,
ELONGATED

1632-XXX-0129

(Compatible with
A0337-XXX Toilet Seat /
sold separately)



Features

- Vitreous China construction
- Wall-hung toilet bowl
- Compatible A0337-XXX toilet seats or with standard elongated toilet seats (sold separately)
- In-wall tank and button control sold separately/compatible with standard in-wall tanks
- Standard siphonic flush

Dimensions

- 13.5" x 21" (height adjustable)



ADA
Compliant

Standard Color



White
(001)

Special Color



Biscuit
(014)

Premium Colors



Matte
White
(002)



Matte
Black
(004)



Black
(005)

Technical Drawing

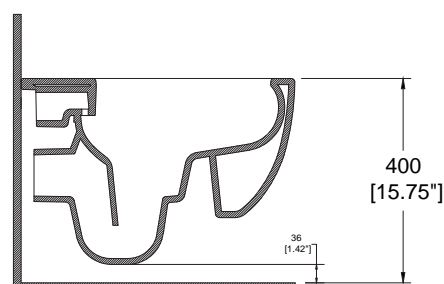
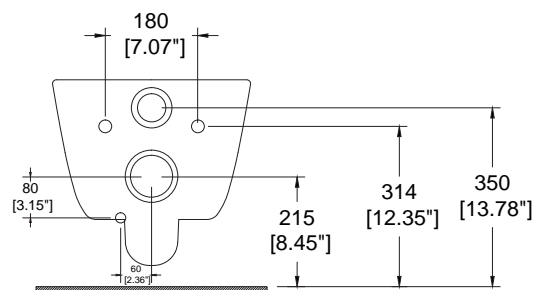
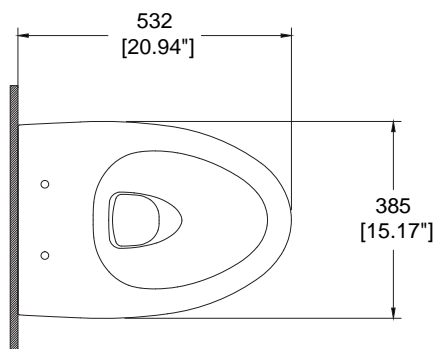





PARMA



1124-XXX-XXXX

Counter Sink (single or 8")
(May be wall-mounted or counter set or
used with metallic console legs)



1123-XXX-XXXX

Counter Sink (single or 8")
(May be wall-mounted or counter set or
used with metallic console legs)



1122-XXX-0126

Counter Sink
(May be wall-mounted)



1384-XXX-0125

Undermount Sink



1124-004-0127
Matte Black

PARMA

COUNTER SINK

1124-XXX-0126

(Single Hole)

1124-XXX-0127

(3-hole)

(May be wall-mounted OR
used with metal console legs)

Features

- Fine Fireclay construction
- Single-hole OR 3-hole faucet setting
- With overflow
- Wall-mounting hardware included

Dimensions

- 33.27" x 19.69" x 5"



ADA
Compliant

Standard Color



White
(001)

Premium Colors



Matte
White
(002)



Matte
Black
(004)



Black
(005)

Technical Drawing

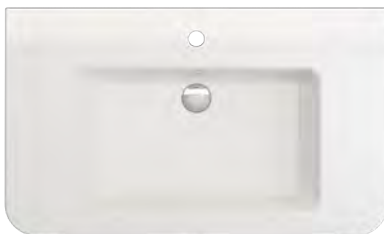

Compatible Products

Metallic Console Leg

3930 0001 S Brushed Nickel

3930 0001 F Matte Black

3930 0001 G Matte Gold

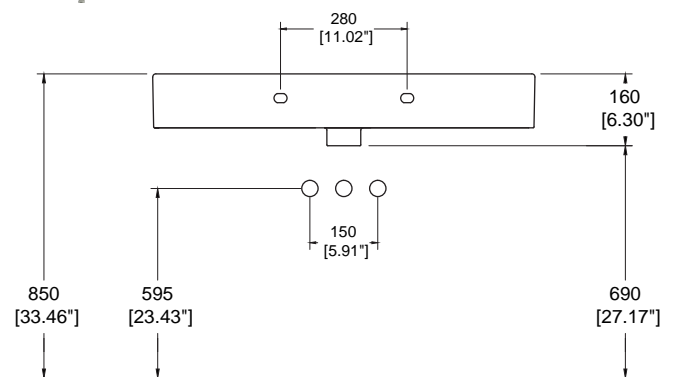
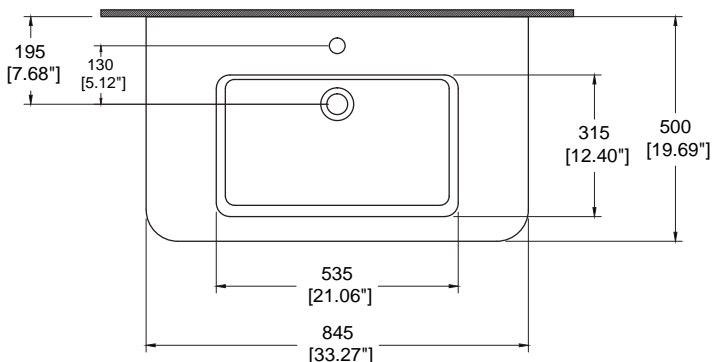



1123-002-0127
Matte White

PARMA

COUNTER SINK

1123-XXX-0126

(Single hole)

1123-XXX-0127

(3-hole)

(May be wall-mounted OR
used with metal console legs)

Features

- Fine Fireclay construction
- Single-hole OR 3-hole faucet setting
- With overflow hole
- Wall-mounting hardware included

Dimensions

- 25.59" x 19.69" x 5"



ADA
Compliant

Standard Color



White
(001)

Premium Colors



Matte
White
(002)



Matte
Black
(004)



Black
(005)

Technical Drawing

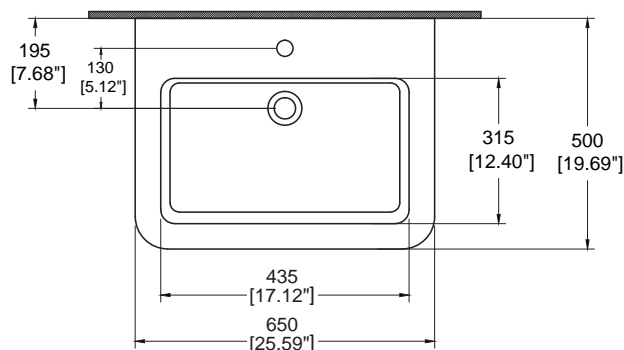
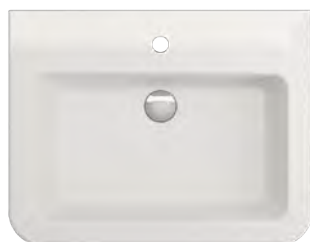

Compatible Products

Metallic Console Leg

3930 0001 S Brushed Nickel

3930 0001 F Matte Black

3930 0001 G Matte Gold

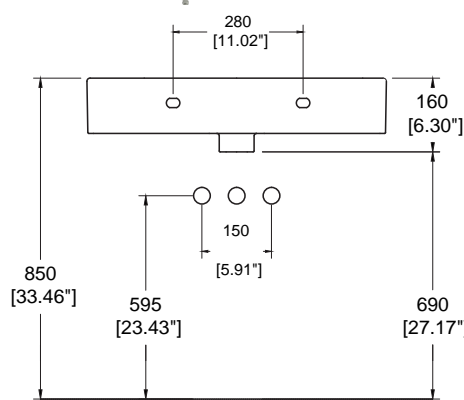



1122-001-0126
White

PARMA

COUNTER SINK

1122-XXX-0126

(May be wall-mounted)

Features

- Fine Fireclay construction
- Single-hole faucet setting
- With overflow hole
- Wall-mounting hardware included

Dimensions

- 19.69" x 19.69" x 5"



ADA
Compliant

Standard Color



White
(001)

Premium Colors



Matte
White
(002)



Matte
Black
(004)



Black
(005)

Technical Drawing

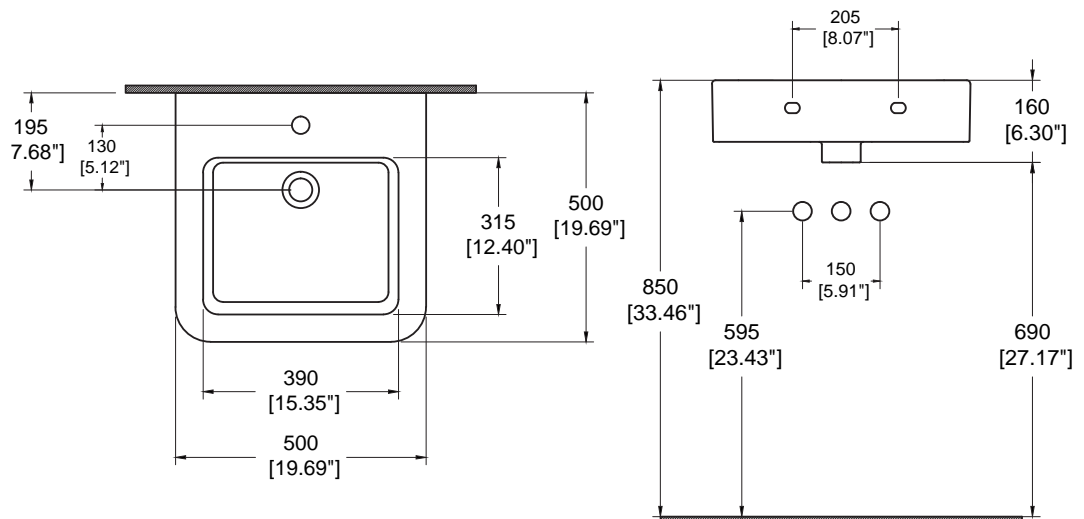





1384-005-0125
Black

PARMA

UNDERMOUNT SINK
1384-XXX-0125

Features

- Fine Fireclay construction
- Includes undermounting hardware
- With overflow hole
- Reversible so overflow may be positioned at front or back

Dimensions

- 22" x 17.5" x 5.75"

Standard Color



White
(001)

Premium Colors



Matte White
(002)



Matte Black
(004)



Black
(005)



Sapphire Blue
(010)

Special Color



Biscuit
(014)

Metallic Colors



Platinum
(401)



Matte Gold
(403)

Technical Drawing

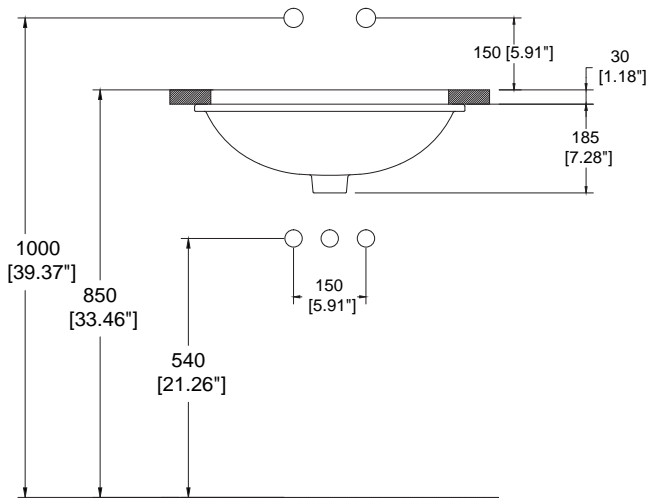
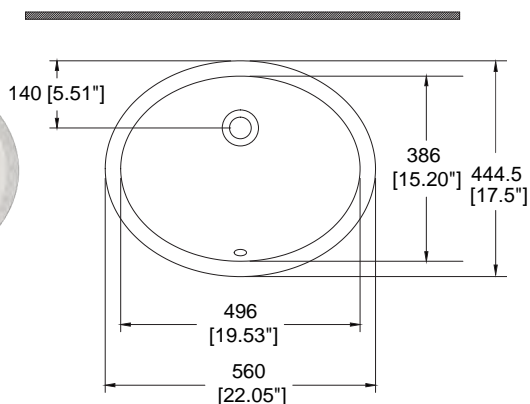





RAVENNA



1111-XXX-0132

Counter Sink
(May be wall-mounted OR
used with metallic console legs)



1105-XXX-XXXX

Counter Sink (single or 8")
(May be wall-mounted, used with matching cabinet base
OR used with metallic console legs)



1113-XXX-XXXX

Counter Sink (single or 8")
(May be wall-mounted OR
used with metallic console legs)



1161-XXX-XXXX

Counter Sink (single or 8")
(May be wall-mounted, used with matching cabinet base,
OR used with metallic console legs)



7019-XXXX-1105

Wall-hung Cabinet Base
(Compatible with 1105-XXX-XXXX sinks)



7019-XXXX-1161

Wall-hung Cabinet Base
(Compatible with 1161-XXX-XXXX sinks)



1111-001-0132
White

RAVENNA

COUNTER SINK

1111-XXX-0132

(May be wall-mounted OR used with metal console legs)

Features

- Fine Fireclay construction
- Double Basin
- Dual single-hole faucet setting
- With overflow hole
- Mounting hardware included

Dimensions

- 48" x 18.75" x 4"



ADA
Compliant

Standard Color



White
(001)

Premium Colors



Matte White
(002)



Matte Black
(004)



Black
(005)

Technical Drawing

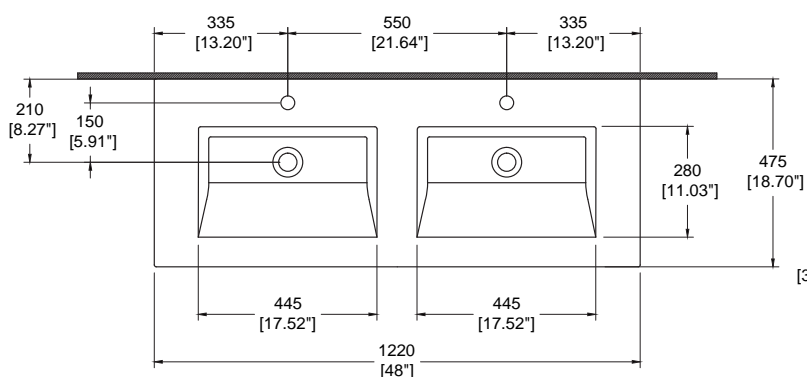

Compatible Products

Metallic Console Leg

3930 0001 S Brushed Nickel

3930 0001 F Matte Black

3930 0001 G Matte Gold

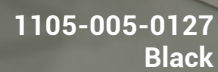

COUNTER SINK

1105-XXX-0126

(Single hole)

1105-XXX-0127

(3-hole)

(May be wall-mounted, used with the 7019-XXXX-1105 cabinet base OR used with metal console legs)

Features

- Fine Fireclay construction
- Single-hole OR 3-hole faucet setting
- With overflow hole
- Mounting hardware included
- Compatible with 7019-XXXX-1105 cabinet base

Dimensions

- 40.5" x 18.75" x 4"



Standard Color



Premium Colors



Technical Drawing

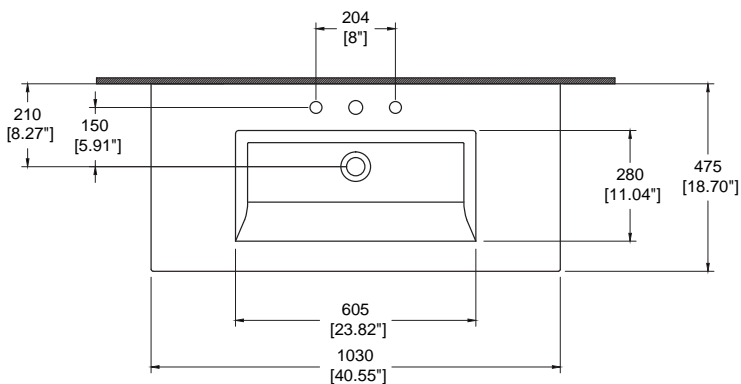

Metallic Console Leg

3930 0001 S Brushed Nickel

3930 0001 F Matte Black

3930 0001 G Matte Gold





1113-001-0126
White

RAVENNA

COUNTER SINK

1113-XXX-0126

(Single hole)

1113-XXX-0127

(3-hole)

(May be wall-mounted, OR used with metallic console legs)

Features

- Fine Fireclay construction
- Single-hole OR 3-hole faucet setting
- With overflow
- Mounting hardware included

Dimensions

- 32" x 18.75" x 4"



ADA
Compliant

Standard Color



White
(001)

Premium Colors



Matte White
(002)



Matte Black
(004)



Black
(005)

Technical Drawing



Compatible Products

Metallic Console Leg

3930 0001 S Brushed Nickel

3930 0001 F Matte Black

3930 0001 G Matte Gold

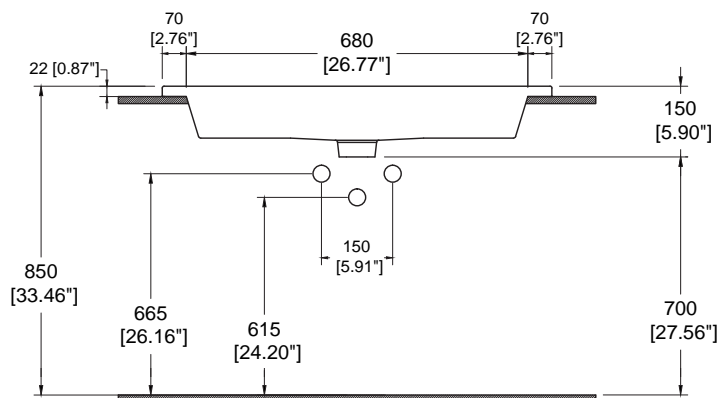
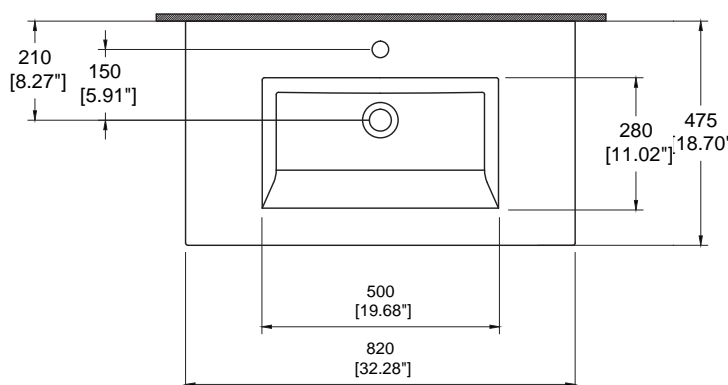

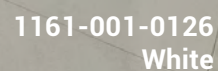

(3-hole)
(May be wall-mounted, OR used
with metallic console legs)

- Fine Fireclay construction
- Single-hole OR 3-hole faucet setting
- With overflow
- Mounting hardware included
- Compatible with 7109-xxxx-1161 cabinet base

- 24.49" x 18.9" x 4"



White
(001)

Matte White
(002)

3930 0001 S Brushed Nickel
3930 0001 F Matte Black
3930 0001 G Matte Gold

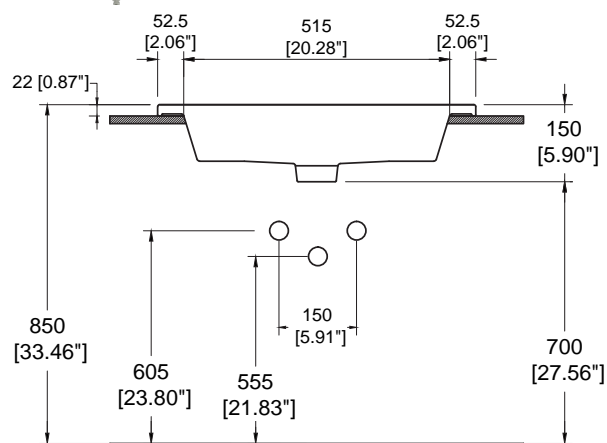
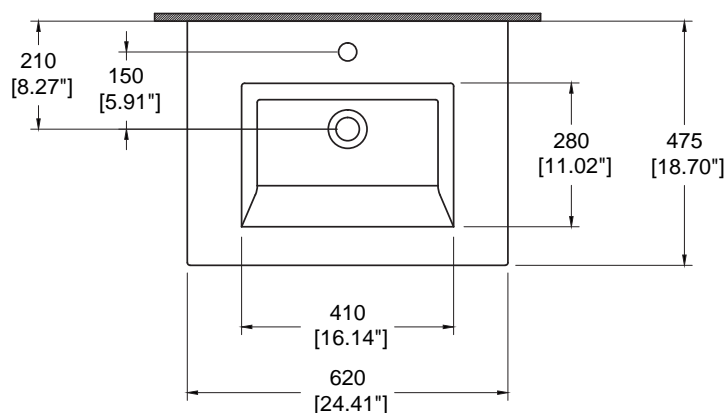



1105-001-0126 top
7019-0109-1105 base
in White



RAVENNA

WALL-HUNG

CABINET BASE

7019-0109-1105

(White)

7019-2017-1105

(Anthracite)

(Compatible with
1105-XXX-XXXX sinks only /
sink sold separately)

Features

- Wall-hung
- Soft-close drawer glides
- Features ultra-durable thermo-foil
- Sinks are available in 4 colors

Dimensions

- 39.5" x 18.5" x 17.25"

Cabinet Colors



White
(0109)



Anthracite
(2017)



Technical Drawing

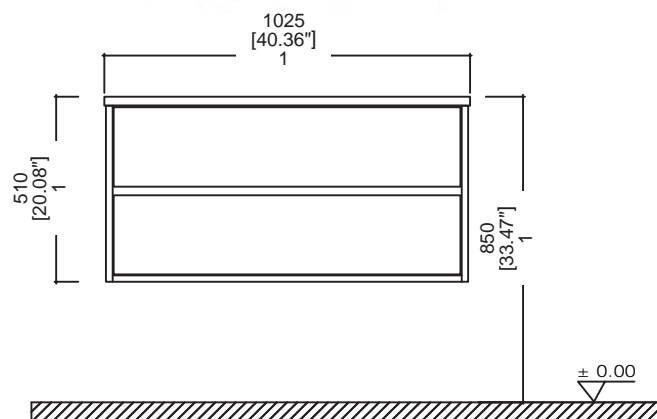
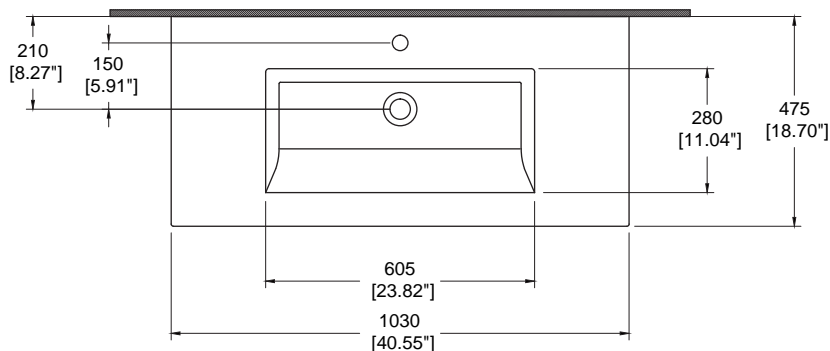



1161-001-0126 top
7019-0101-1161 base
in White

RAVENNA

WALL-HUNG

CABINET BASE

7019-0101-1161

(White)

7019-2009-1161

(Anthracite)

(Compatible with
1161-XXX-XXXX sinks only /
sink sold separately)

Features

- Wall-hung
- Soft-close drawer glides
- Features ultra-durable thermo-foil
- Sinks are available in 4 colors

Dimensions

- 23.75" x 18.5" x 13.75"

Cabinet Colors



White
(0101)



Anthracite
(2009)



Technical Drawing

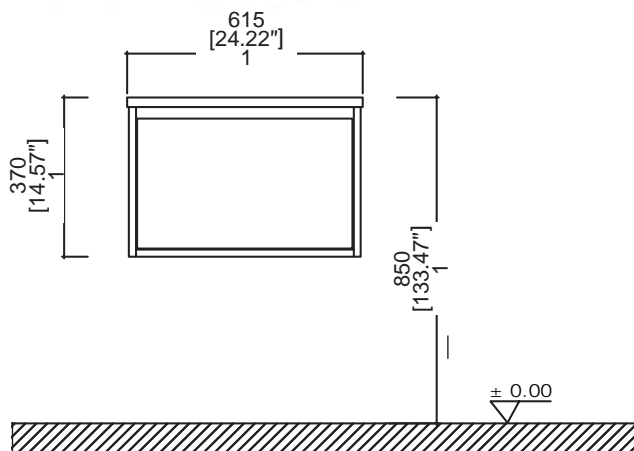
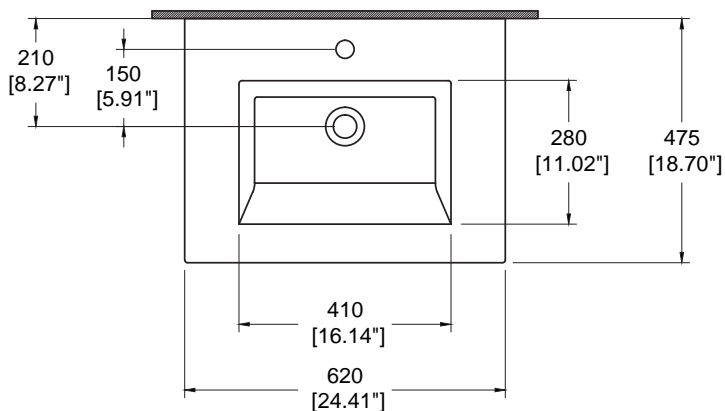



SCALA



1006-XXX-0125
Undermount Sink





1006-001-0125
White



SCALA

UNDERMOUNT SINK
1006-XXX-0125

Features

- Fine Fireclay construction
- With overflow
- Includes undermounting hardware
- Reversible so overflow may be positioned at front or back

Dimensions

- 21.5" x 16" x 7.25"

Standard Color



White
(001)

Premium Colors



Matte White
(002)



Matte Black
(004)



Black
(005)



Sapphire Blue
(010)

Special Color



Biscuit
(014)

Metallic Colors



Platinum
(401)



Matte Gold
(403)

Technical Drawing

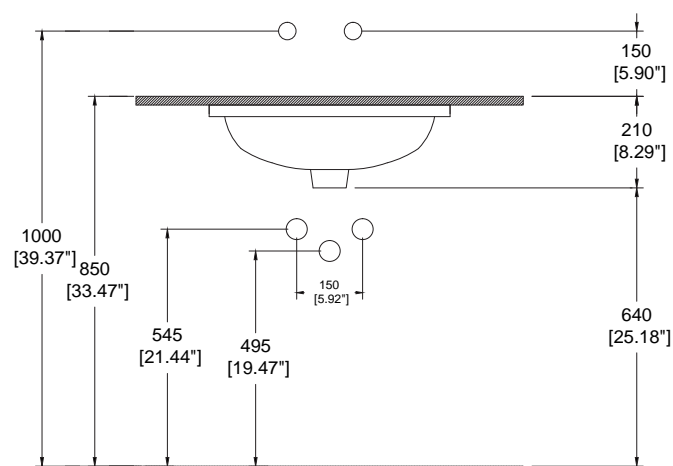
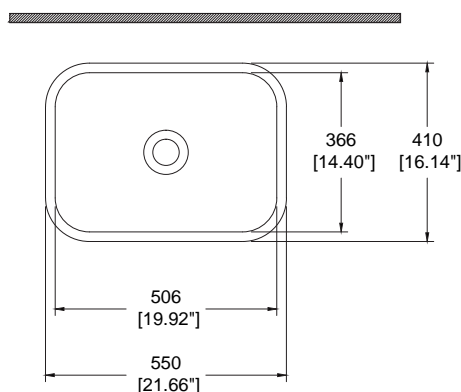



SCALA ARCH



1079-XXX-XXXX

Counter Sink (single or 8")
(May be wall-mounted
OR used with metallic console legs)



1078-XXX-XXXX

Counter Sink (single or 8")
(May be wall-mounted
OR used with metallic console legs)



1077-XXX-XXXX

Counter Sink (single or 8")
(May be wall-mounted OR used with
metallic console legs)



1076-XXX-0126

Counter Sink
(May be wall-mounted
OR used with metallic console legs)



7006-XXXX-1079

Wall-hung Cabinet Base
(Compatible with 1079-XXX-XXXX sinks)



7006-XXXX-1077

Wall-hung Cabinet Base
(Compatible with 1077-XXX-XXXX sinks)



1079-002-0126
Matte White



SCALA ARCH

COUNTER SINK
1079-XXX-0126
(Single hole)

1079-XXX-0127
(3-hole)

(May be wall-mounted, used with the 7006-XXXX-1079 cabinet base, OR used with metallic console legs)

Features

- Fine Fireclay construction
- Single-hole OR 3-hole faucet setting
- With overflow hole
- Wall-mounting hardware included
- Compatible with 7006-XXXX-1079 cabinet base

Dimensions

• 40" x 19" x 4"

Standard Color



White
(001)

Premium Colors



Matte White
(002)



Matte Black
(004)



Black
(005)



Matte Gray
(006)

Special Color



Biscuit
(014)



Sapphire Blue
(010)



Orange
(012)



Matte Ice Blue
(029)



Matte Mint Green
(033)

Technical Drawing

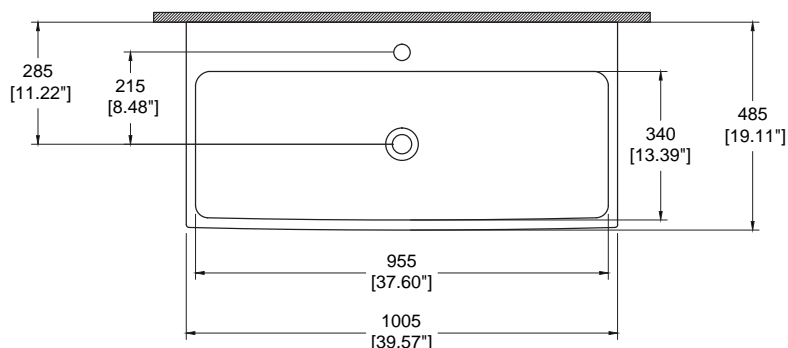

Compatible Products

Metallic Console Leg

3930 0001 S Brushed Nickel

3930 0001 F Matte Black

3930 0001 G Matte Gold

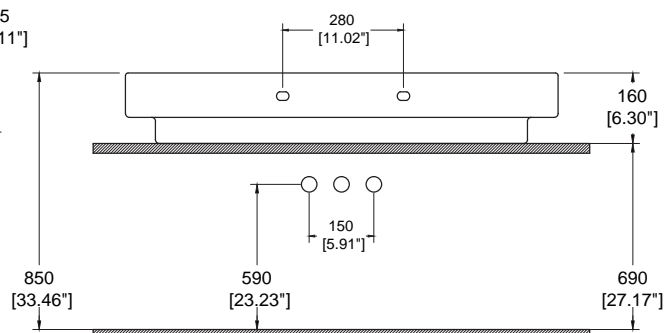



1079-001-0126 top
7006-0122-1079 base
in White



SCALA ARCH

WALL-HUNG
CABINET BASE

7006-0122-1079

(White)

7006-0824-1079

(Anthracite)

(Compatible with
1079-XXX-XXXX sinks only /
sink sold separately)

Cabinet
Colors



White
(0122)



Anthracite
(0824)

Features

- Wall-hung
- Soft-close drawer glides
- Features ultra-durable thermo-foil
- Sinks are available in 10 colors

Dimensions

- 38.75" x 18.5" x 16.5"



Technical Drawing

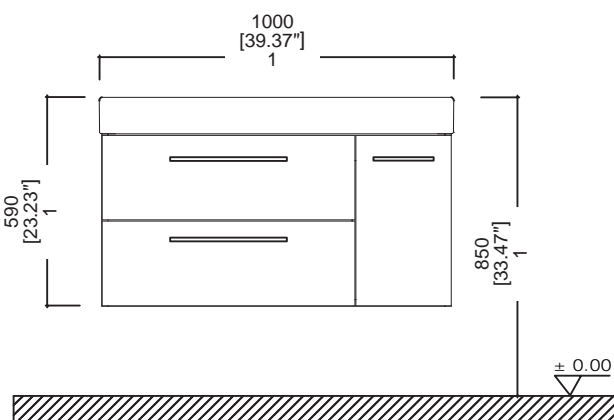
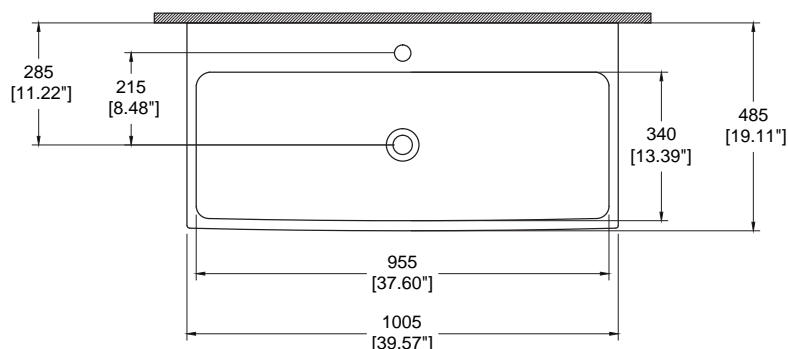



1078-006-0127
Matte Gray



SCALA ARCH

COUNTER SINK

1078-XXX-0126

(Single hole)

1078-XXX-0127

(3-hole)

(May be wall-mounted OR used with metallic console legs)

Features

- Fine Fireclay construction
- Single-hole OR 3-hole faucet setting
- With overflow hole
- Wall-mounting hardware included

Dimensions

- 31.5" x 18.75" x 4"

Standard Color



White
(001)

Premium Colors



Matte White
(002)



Matte Black
(004)



Black
(005)



Matte Gray
(006)

Special Color



Biscuit
(014)



Sapphire Blue
(010)



Orange
(012)



Matte Ice Blue
(029)



Matte Mint Green
(033)

Technical Drawing

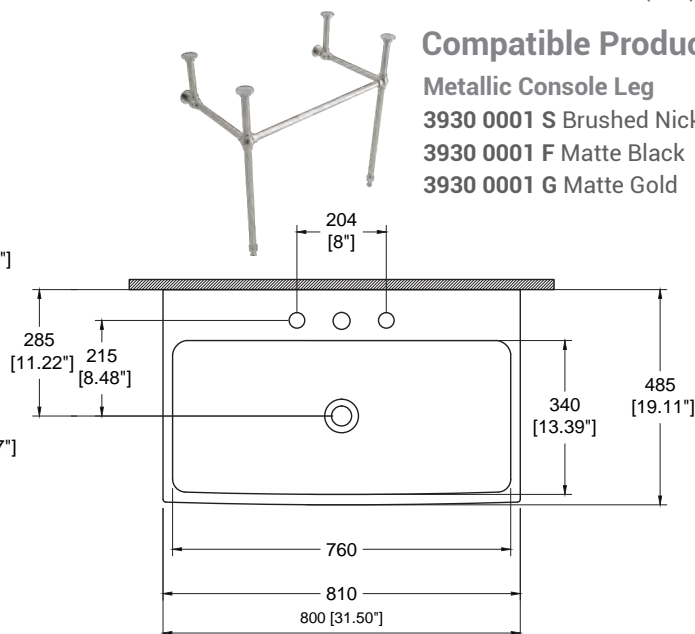
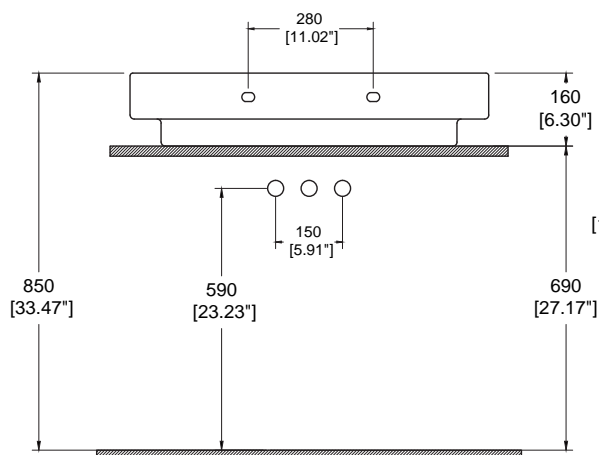

Compatible Products

Metallic Console Leg

3930 0001 S Brushed Nickel

3930 0001 F Matte Black

3930 0001 G Matte Gold



1077-029-0127
Matte Ice Blue



SCALA ARCH

CAUNTER SINK
1077-XXX-0126
(Single hole)

1077-XXX-0127
(3-hole)
(May be wall-mounted, used with the 7006-XXXX-1077 cabinet base, OR used with metallic console legs)

Features

- Fine Fireclay construction
- Single-hole OR 3-hole faucet setting
- With overflow hole
- Wall-mounting hardware included
- Compatible with 7006-XXXX-1077 cabinet base

Dimensions

• 23.75" x 19" x 4"

Standard Color



White
(001)

Premium Colors



Matte White
(002)



Matte Black
(004)



Black
(005)



Matte Gray
(006)

Special Color



Biscuit
(014)



Sapphire Blue
(010)



Orange
(012)



Matte Ice Blue
(029)



Matte Mint Green
(033)

Technical Drawing

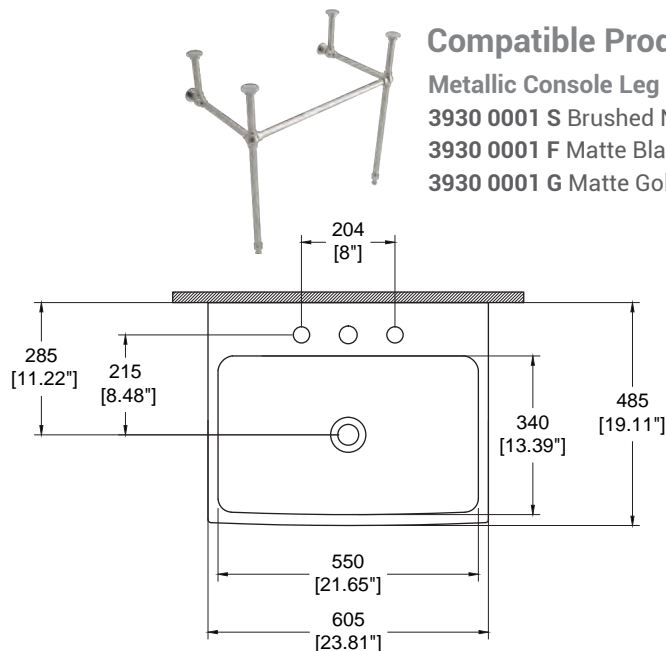
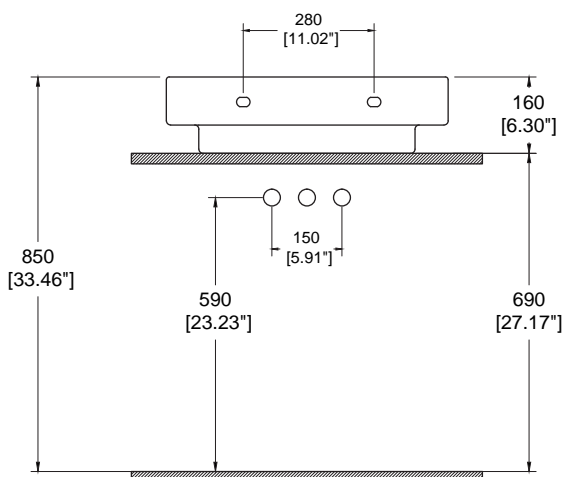

Compatible Products

Metallic Console Leg

- 3930 0001 S** Brushed Nickel
- 3930 0001 F** Matte Black
- 3930 0001 G** Matte Gold



SCALA ARCH

WALL-HUNG

CABINET BASE

7006-0106-1077

(White)

7006-2008-1077

(Anthracite)

(Compatible with
1077-XXX-XXXX sinks only /
sink sold separately)

Features

- Wall-hung
- Soft-close drawer glides
- Features ultra-durable thermo-foil

Dimensions

• 23.75" x 18.5" x 11.75"

Cabinet Colors



Technical Drawing

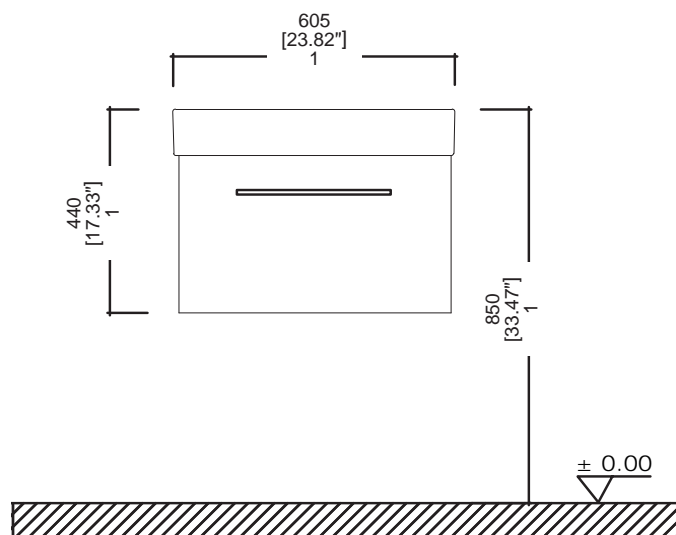
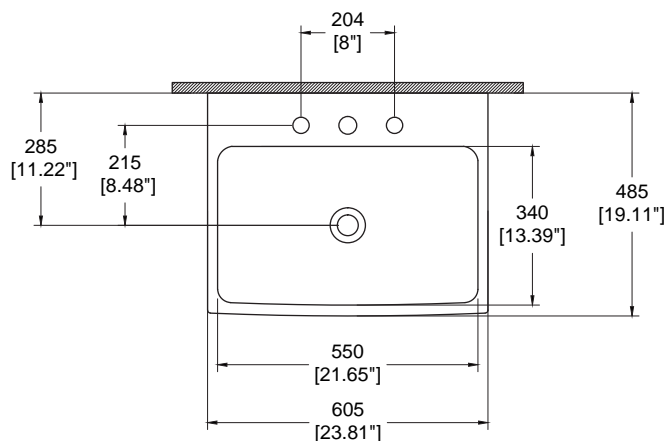



1076-033-0126
Matte Mint Green



SCALA ARCH

COUNTER SINK

1076-XXX-0126

(Single hole)

1076-XXX-0127

(3-hole)

(May be wall-mounted OR used with metallic console legs)

Features

- Fine Fireclay construction
- Single-hole OR 3-hole faucet setting
- With overflow hole
- Wall-mounting hardware included

Dimensions

- 19" x 19" x 4"

Standard Color



White
(001)

Premium Colors



Matte White
(002)



Matte Black
(004)



Black
(005)



Matte Gray
(006)

Special Color



Biscuit
(014)



Sapphire Blue
(010)



Orange
(012)



Matte Ice Blue
(029)



Matte Mint Green
(033)

Technical Drawing

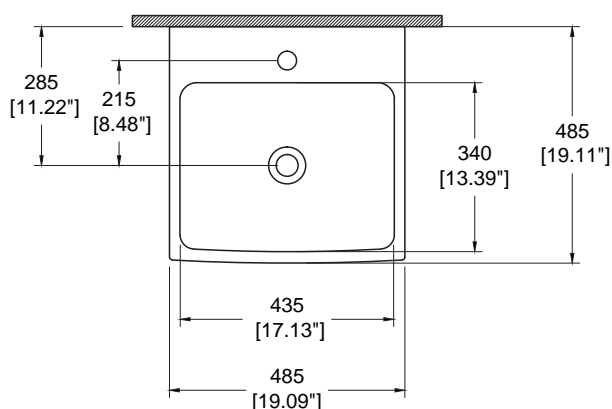

Compatible Products

Metallic Console Leg

- 3930 0001 S Brushed Nickel
- 3930 0001 F Matte Black
- 3930 0001 G Matte Gold

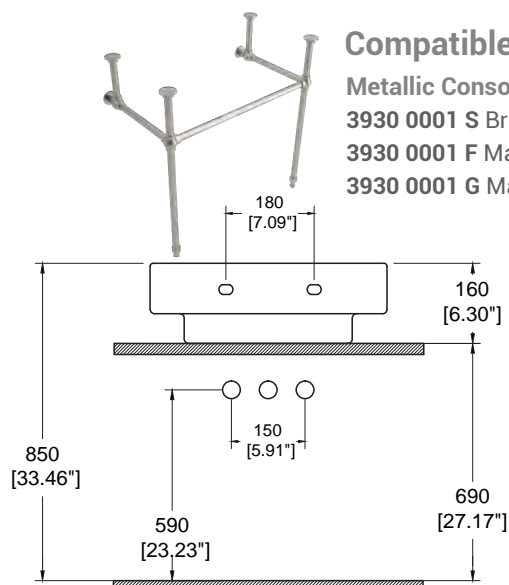



SOTTILE



1470-XXX-0126
Vessel



1471-XXX-0125
Vessel



1476-XXX-0125
Vessel



1477-XXX-0125
Vessel



1478-XXX-0125
Vessel



1479-XXX-0126
Vessel



1494-XXX-0125
Vessel



1521-XXX-0125
Vessel



1598-XXX-0126
Vessel



1599-XXX-0126
Vessel



1600-XXX-0126
Vessel



1470-001-0126
White



SOTTILE

VESSEL SINK
1470-XXX-0126

Features

- Fine Fireclay construction
- Single-hole faucet
- 1219-XXX color-matched pop-up drain and cover sold separately

Dimensions

• 12" x 9.2" x 4"

Standard Color



White
(001)

Premium Colors



Matte White
(002)



Matte Black
(004)



Black
(005)



Matte Gray
(006)



Sapphire Blue
(010)



Orange
(012)



Matte Ice Blue
(029)



Matte Mint Green
(033)

Special Color



Biscuit
(014)

Metallic Colors



Platinum
(401)



Matte Gold
(403)

Technical Drawing

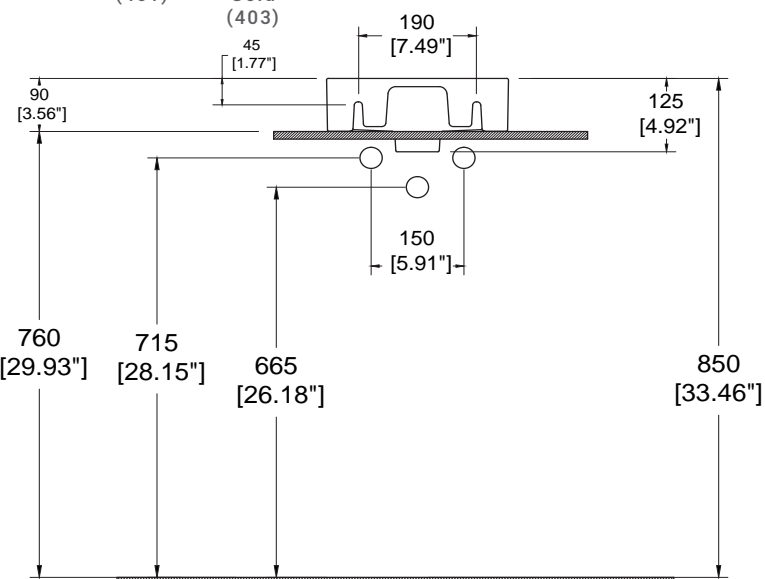
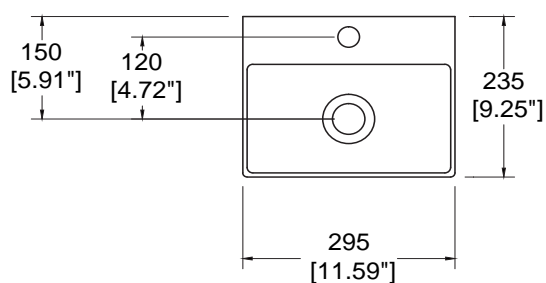



1471-001-0125
White



SOTTILE

VESSEL SINK
1471-XXX-0125

Features

- Fine Fireclay construction
- 1219-XXX color-matched pop-up drain and cover sold separately

Dimensions

• $\varnothing 10'' \times 5''$

Standard Color



White
(001)

Premium Colors



Matte White
(002)



Matte Black
(004)



Black
(005)



Matte Gray
(006)



Sapphire Blue
(010)



Orange
(012)



Matte Ice Blue
(029)



Matte Mint Green
(033)

Special Color



Biscuit
(014)

Metallic Colors



Platinum
(401)



Matte Gold
(403)

Technical Drawing

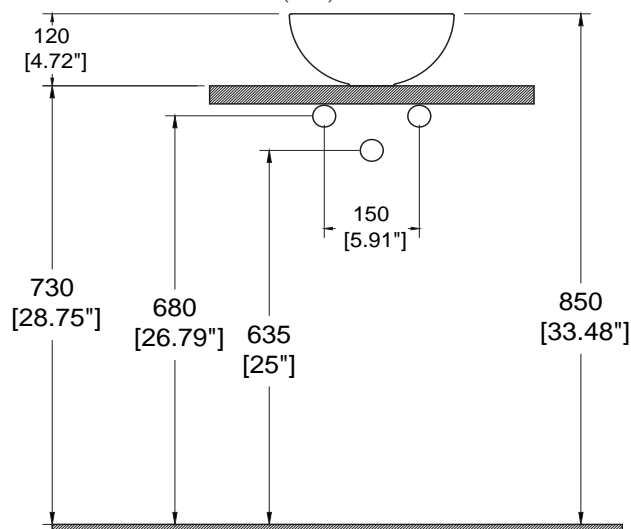
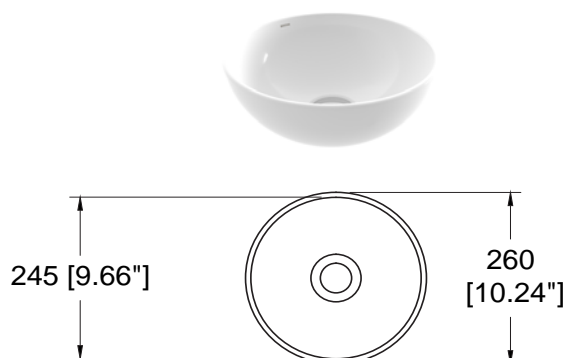



1476-001-0125
White



SOTTILE

VESSEL SINK
1476-XXX-0125

Features

- Fine Fireclay construction
- 1219-XXX color-matched pop-up drain and cover sold separately

Dimensions

- 22.5" x 15" x 5"

Standard Color



White
(001)

Premium Colors



Matte White
(002)



Matte Black
(004)



Black
(005)



Matte Gray
(006)



Sapphire Blue
(010)



Orange
(012)



Matte Ice Blue
(029)



Matte Mint Green
(033)

Special Color



Biscuit
(014)

Metallic Colors



Platinum
(401)



Matte Gold
(403)

Technical Drawing

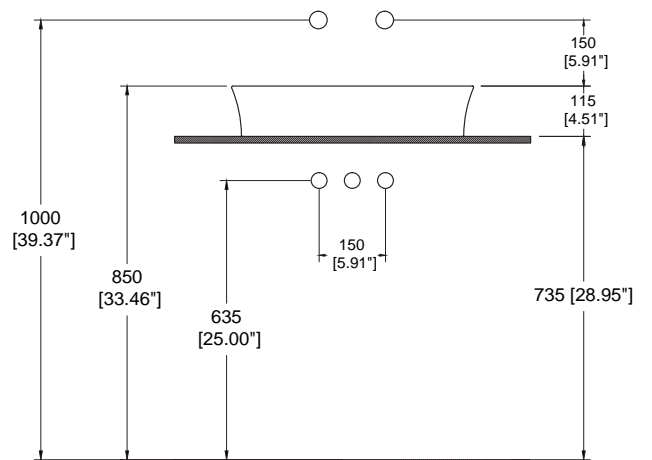
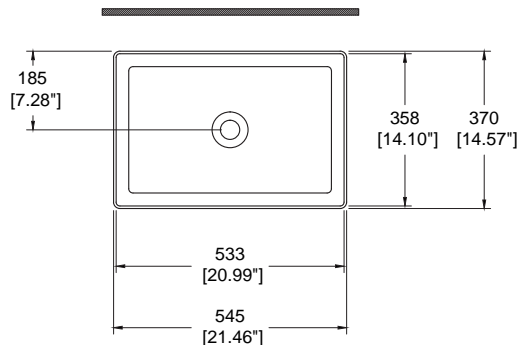



1477-010-0125
Sapphire Blue



SOTTILE

VESSEL SINK

1477-XXX-0125

Features

- Fine Fireclay construction
- 1219-XXX color-matched pop-up drain and cover sold separately

Dimensions

- 15.25" x 15.25" x 5"

Standard Color



White
(001)

Premium Colors



Matte White
(002)



Matte Black
(004)



Black
(005)



Matte Gray
(006)



Sapphire Blue
(010)



Orange
(012)



Matte Ice Blue
(029)



Matte Mint Green
(033)

Special Color



Biscuit
(014)

Metallic Colors



Platinum
(401)



Matte Gold
(403)

Technical Drawing

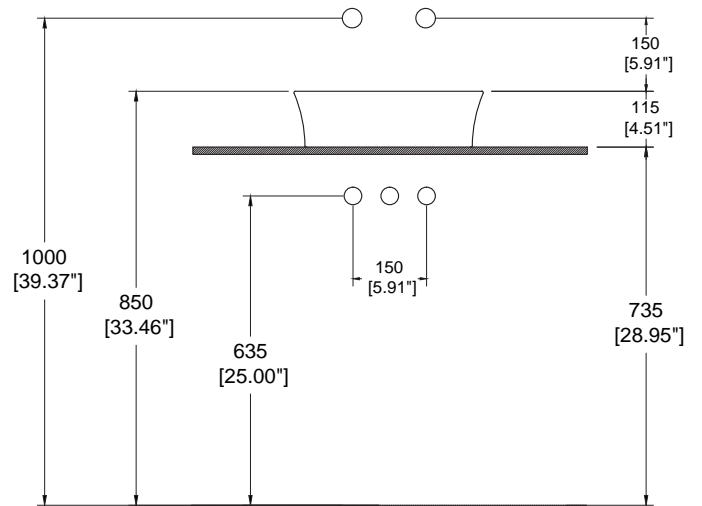
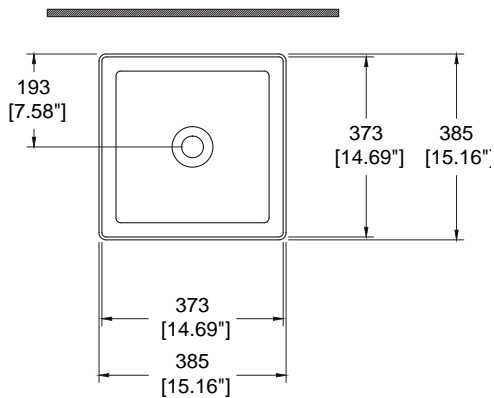

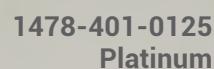

VESSEL SINK

1478-XXX-0125

Dimensions

- Fine Fireclay construction
- 1219-XXX color-matched pop-up drain and cover sold separately

- Ø15" x 5"

White
(001)

Matte
White
(002)



Matte
Black
(004)



Black
(005)



Matte
Gray
(006)



Sapphire
Blue
(010)



Orange
(012)



Matte
Ice Blue
(029)



Matte
Mint
Green
(033)

Biscuit
(014)

Platinum
(401)

Matte
Gold
(403)

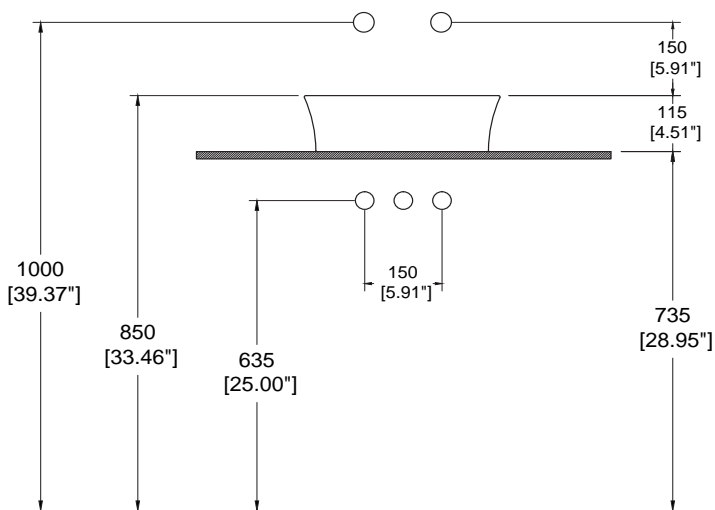
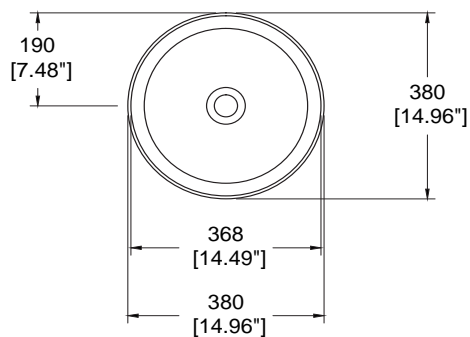



1479-403-0126
Matte Gold



SOTTILE

VESSEL SINK
1479-XXX-0126

Features

- Fine Fireclay construction
- Offset Single Hole Faucet (reversible)
- 1219-XXX color-matched pop-up drain and cover sold separately
- With overflow

Dimensions

- 23.5" x 15" x 4.5"

Standard Color



White
(001)

Premium Colors



Matte White
(002)



Matte Black
(004)



Black
(005)



Matte Gray
(006)



Sapphire Blue
(010)



Orange
(012)



Matte Ice Blue
(029)



Matte Mint Green
(033)

Special Color



Biscuit
(014)

Metallic Colors



Platinum
(401)



Matte Gold
(403)

Technical Drawing

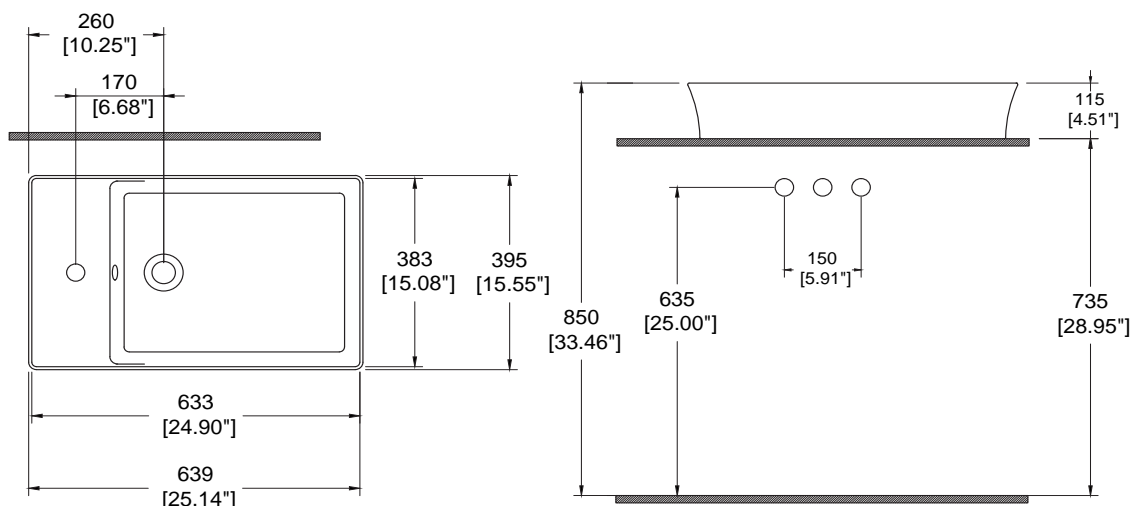



1494-001-0125
White



SOTTILE

VESSEL SINK

1494-XXX-0125

Features

- Fine Fireclay construction
- 1219-XXX color-matched pop-up drain and cover sold separately

Dimensions

• $\varnothing 15"$ x 5"

Standard Color



White
(001)

Premium Colors



Matte White
(002)



Matte Black
(004)



Black
(005)



Matte Gray
(006)



Sapphire Blue
(010)



Orange
(012)



Matte Ice Blue
(029)



Matte Mint Green
(033)

Special Color



Biscuit
(014)

Metallic Colors



Platinum
(401)



Matte Gold
(403)

Technical Drawing

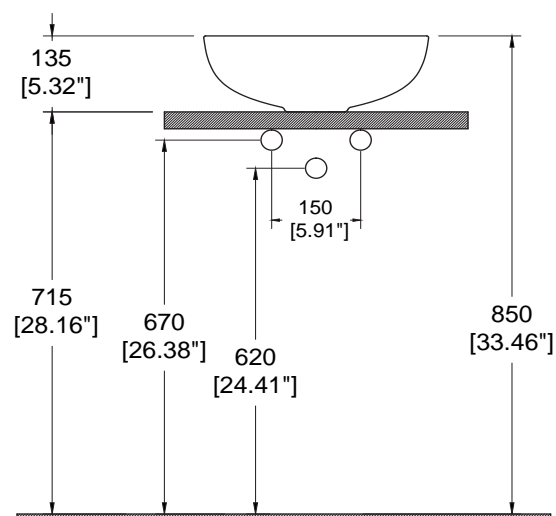
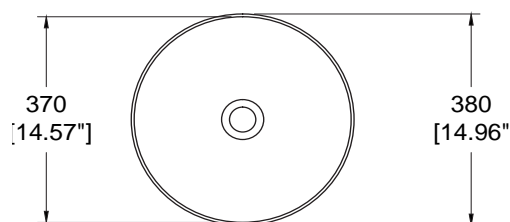



1521-001-0125
White



SOTTILE

VESSEL SINK

1521-XXX-0125

Features

- Fine Fireclay construction
- 1219-XXX color-matched pop-up drain and cover sold separately

Dimensions

- 22" x 15" x 4.5"

Standard Color



White
(001)

Premium Colors



Matte White
(002)



Matte Black
(004)



Black
(005)



Matte Gray
(006)



Sapphire Blue
(010)



Orange
(012)



Matte Ice Blue
(029)



Matte Mint Green
(033)

Special Color



Biscuit
(014)

Metallic Colors



Platinum
(401)



Matte Gold
(403)

Technical Drawing

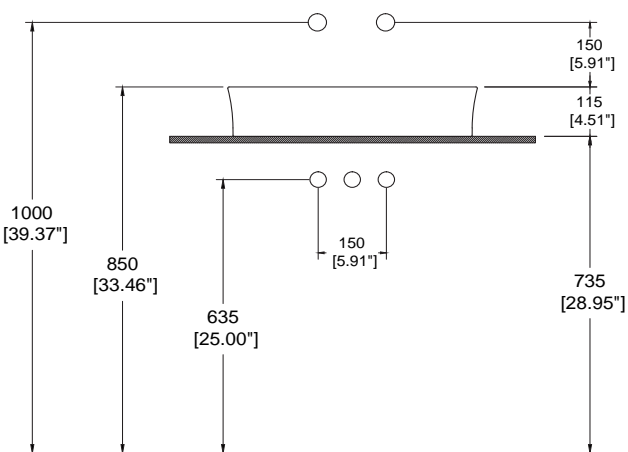
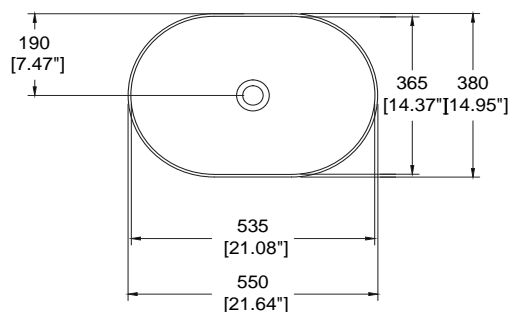



1598-005-0126
Black



SOTTILE

VESSEL SINK

1598-XXX-0125

Features

- Fine Fireclay construction
- 1219-XXX color-matched pop-up drain and cover sold separately
- Single Hole Faucet

Dimensions

- 18" x 18" x 4.5"

Standard Color



White
(001)

Premium Colors



Matte White
(002)



Matte Black
(004)



Black
(005)



Matte Gray
(006)



Sapphire Blue
(010)



Orange
(012)



Matte Ice Blue
(029)



Matte Mint Green
(033)

Special Color



Biscuit
(014)

Metallic Colors



Platinum
(401)



Matte Gold
(403)

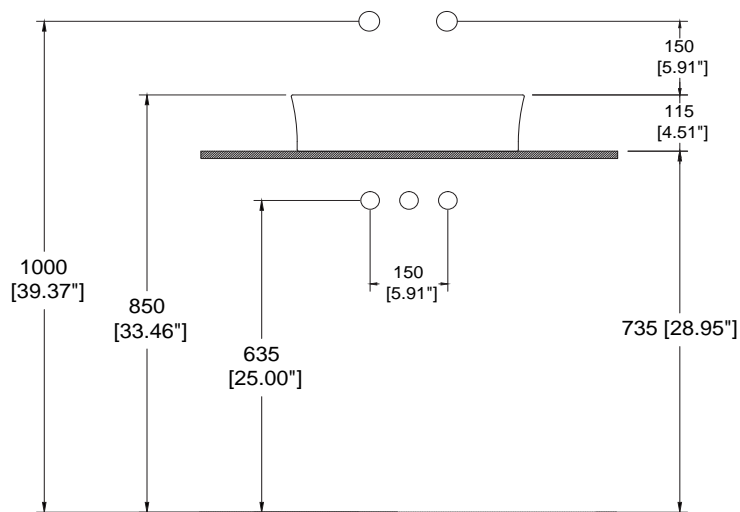
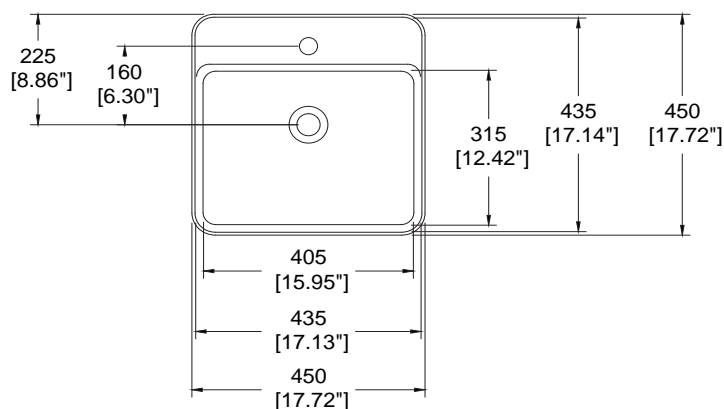



1599-001-0126
White



SOTTILE

VESSEL SINK

1599-XXX-0125

Features

- Fine Fireclay construction
- Single Hole Faucet
- 1219-XXX color-matched pop-up drain and cover sold separately

Dimensions

• $\varnothing 18'' \times 4.5''$

Standard Color



White
(001)

Premium Colors



Matte White
(002)



Matte Black
(004)



Black
(005)



Matte Gray
(006)



Sapphire Blue
(010)



Orange
(012)



Matte Ice Blue
(029)



Matte Mint Green
(033)

Special Color



Biscuit
(014)

Metallic Colors



Platinum
(401)



Matte Gold
(403)

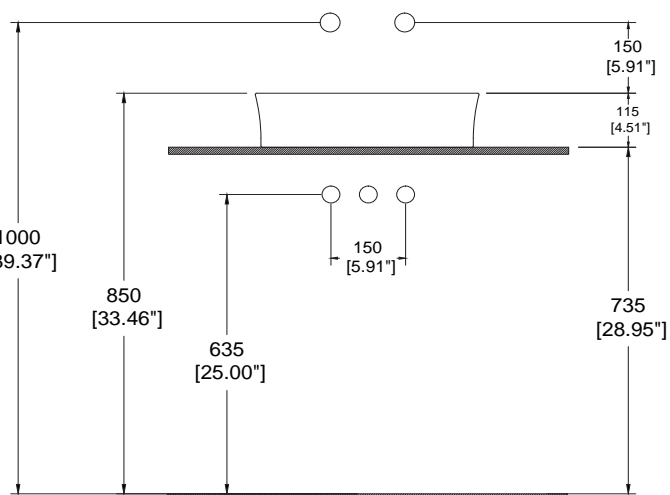
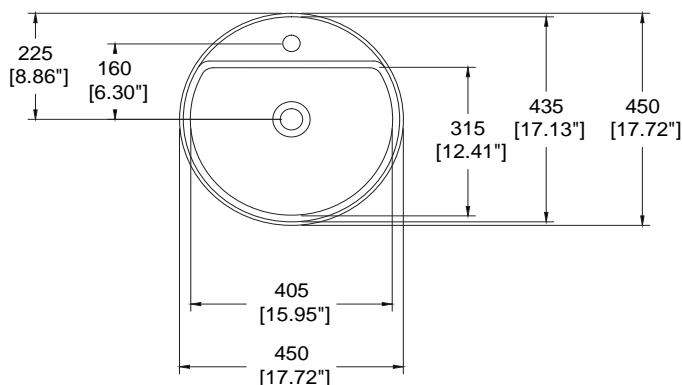



1600-005-0125
Black



SOTTILE

VESSEL SINK

1600-XXX-0125

Features

- Fine Fireclay construction
- 1219-XXX color-matched pop-up drain and cover sold separately
- Single Hole Faucet

Dimensions

- 24" x 18" x 4.5"

Standard Color



White
(001)

Premium Colors



Matte White
(002)



Matte Black
(004)



Black
(005)



Matte Gray
(006)



Sapphire Blue
(010)



Orange
(012)



Matte Ice Blue
(029)



Matte Mint Green
(033)

Special Color



Biscuit
(014)

Metallic Colors



Platinum
(401)



Matte Gold
(403)

Technical Drawing

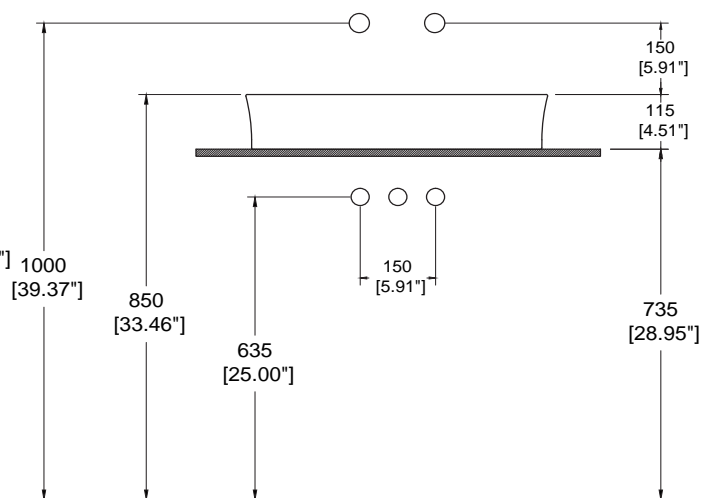
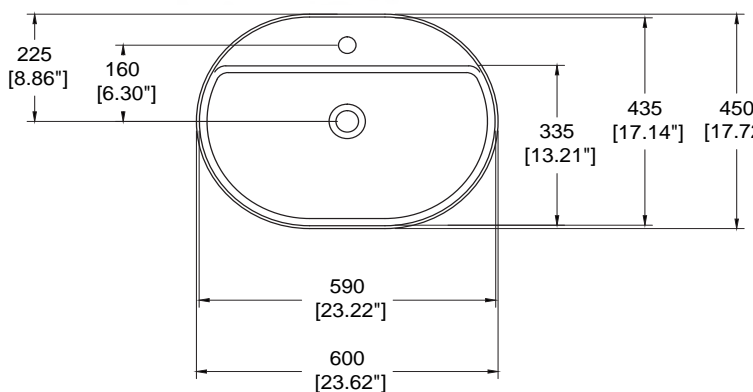

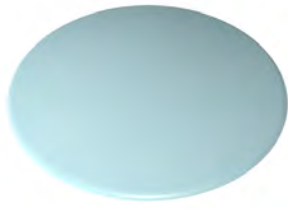

1219-XXX

PUP-UP DRAIN and COLOR-MATCHED COVER

- Compatible with standard USA drain sizes
- Cover is actual color-matched fireclay
- Drain and base pop-up piece are finished chrome
- Sold separately
- Fits all Sottile and Venezia vessels

- 1219-001 white
- 1219-014 biscuit
- 1219-002 matte white
- 1219-004 matte black
- 1219-005 black
- 1219-006 matte gray
- 1219-010 sapphire blue
- 1219-012 orange
- 1219-029 matte ice blue
- 1219-033 matte mint green
- 1219-401 platinum
- 1219-403 matte gold





TAORMINA



1008-XXX-XXXX

Lavatory Sink



1007-XXX-XXXX

Lavatory Sink

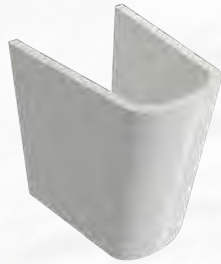

1003-XXX-0338

Trap Cover,
matches 1008 & 1007 tops



1002-XXX-0320

Pedestal Base,
matches 1008 & 1007 tops



1008-001-0126
White



TAORMINA

COUNTER SINK
1008-XXX-0126
(Single Hole)

1008-XXX-0127
(3-hole)

Features

- Fine Fireclay construction
- Single-hole OR 3-hole faucet setting
- With overflow
- Mounting hardware included
- May be used with 1003 trap cover OR 1002 pedestal base

Dimensions

- 33.5" x 19"



ADA
Compliant

Standard
Color



White
(001)

Special
Colors



Biscuit
(014)

Premium
Colors



Matte
White
(002)

Technical Drawing

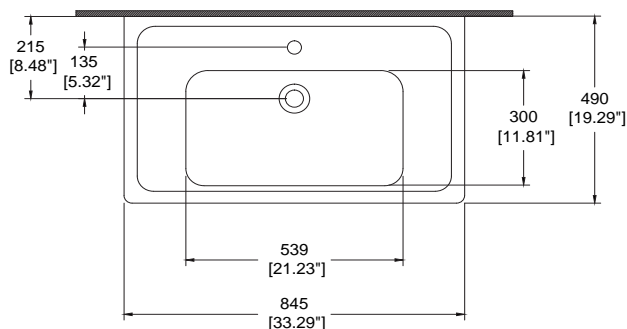

Compatible with
1003-xxx-0338

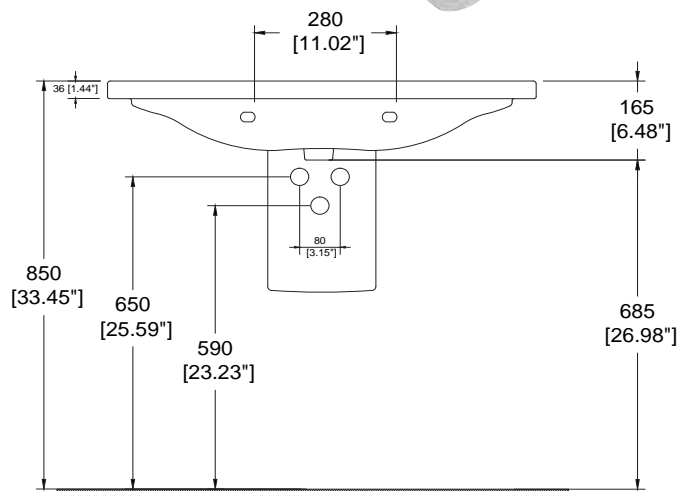

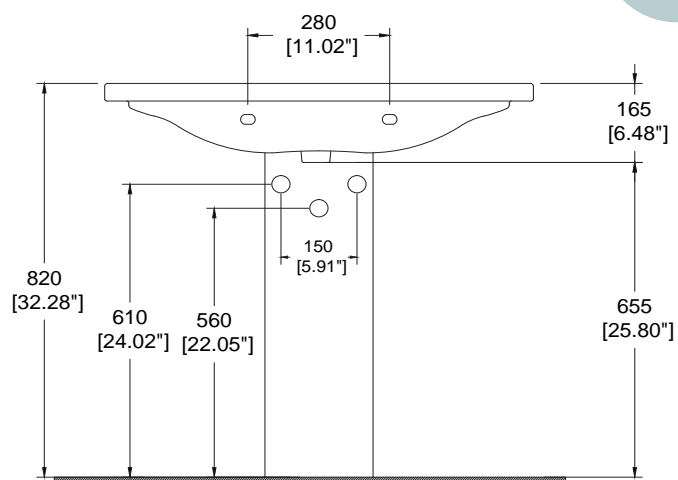

Compatible with
1002-xxx-0320
Pedestal





1007-001-0126
White



TAORMINA

LAVOTARY SINK

1007-XXX-0126

(Single Hole)

1007-XXX-0127

(3-hole)

Technical Drawing

Features

- Fine Fireclay construction
- Single-hole OR 3-hole faucet setting
- With overflow
- Mounting hardware included
- May be used with 1003 trap cover OR 1002 pedestal base

Dimensions

- 26" x 19.25"



ADA
Compliant

Standard
Color



White
(001)

Special
Colors



Biscuit
(014)

Premium
Colors



Matte
White
(002)



Compatible with
1003-xxx-0338

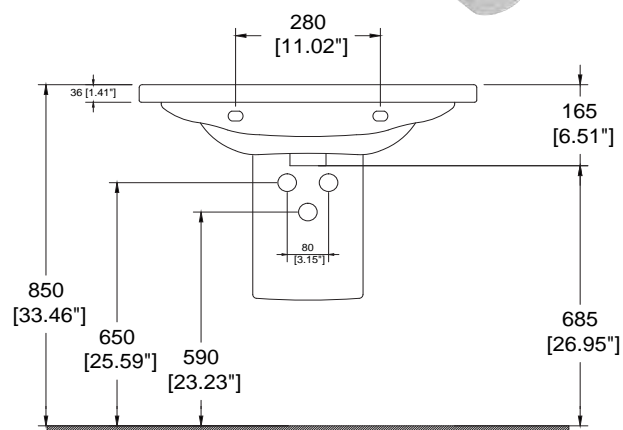
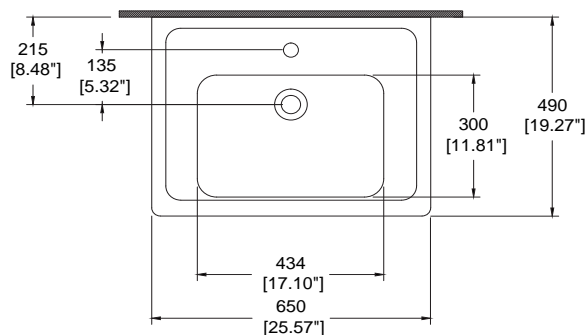

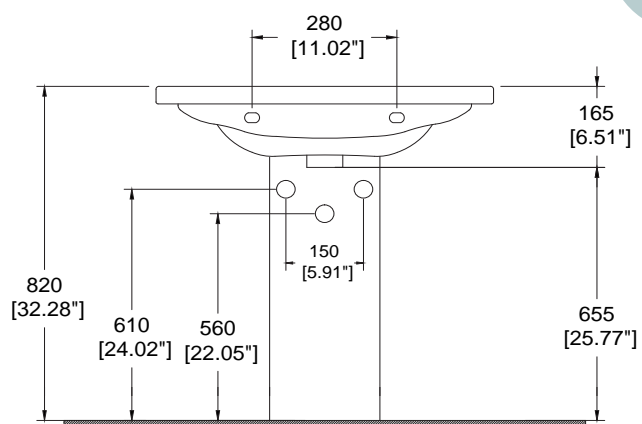

Compatible with
1002-xxx-0320
 Pedestal





VENEZIA



1120-XXX-0125

Vessel

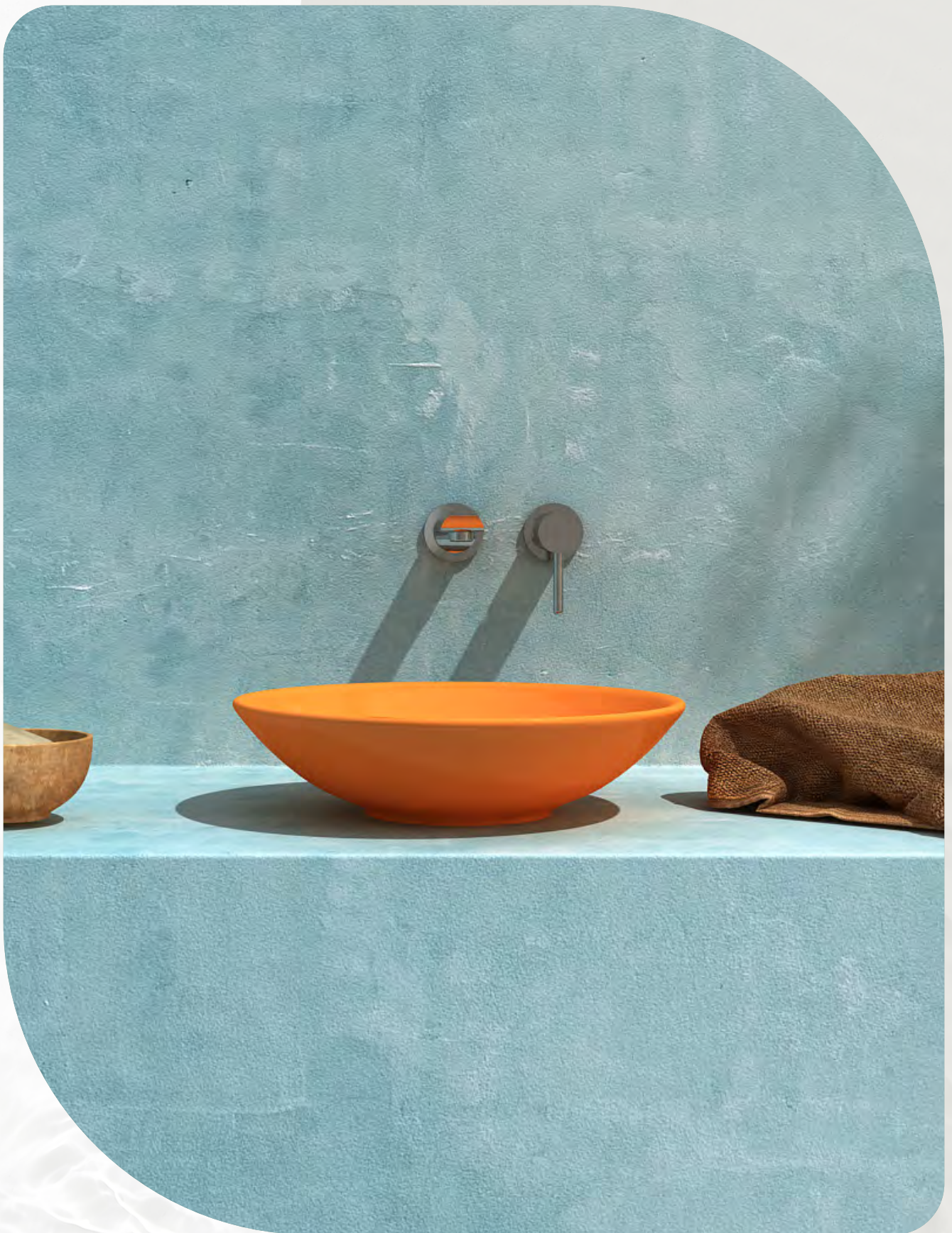



1120-403-0125
Matte Gold



VENEZIA

VESSEL

1120-XXX-0125

Features

- Fine Fireclay construction
- 1219-XXX color-matched pop-up drain and cover sold separately

Dimensions

• $\varnothing 15.75'' \times 4''$

Standard Color



White
(001)

Premium Colors



Matte White
(002)



Matte Black
(004)



Black
(005)



Matte Gray
(006)



Sapphire Blue
(010)



Orange
(012)



Matte Ice Blue
(029)



Matte Mint Green
(033)

Special Color



Biscuit
(014)

Metallic Colors



Platinum
(401)



Matte Gold
(403)

Technical Drawing

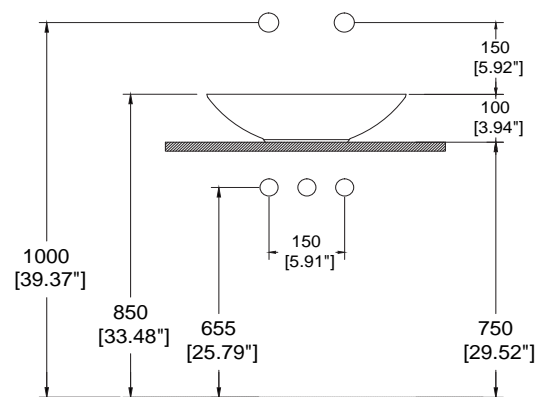
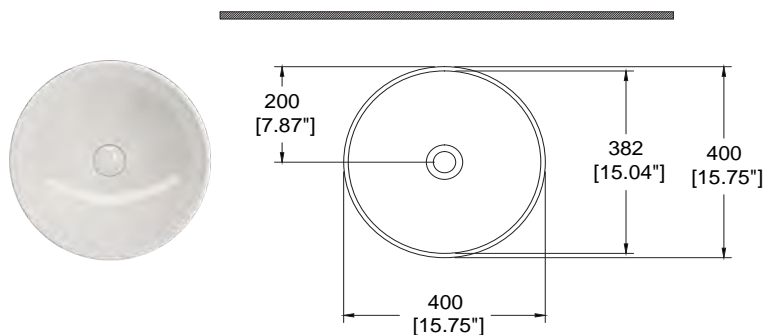



VETTORE



1416-XXX-0129
Wall-Hung Toilet Bowl





1416-005-0129
Black



VETTORE

WALL-HUNG
TOILET BOWL

1416-XXX-0129

(Compatible with
A0330-XXX Toilet Seat /
sold separately)

Features

- Vitreous China construction
- Wall-hung toilet bowl
- Compatible with A0330 soft-close toilet seat (sold separately)
- In-wall tank and button control sold separately/compatible with standard in-wall tanks

Dimensions

- 14.25" x 21.5"
(height adjustable)

Standard Color



White
(001)

Premium Colors



Matte
White
(002)



Matte
Black
(004)



Black
(005)

Special Color



Biscuit
(014)

Technical Drawing

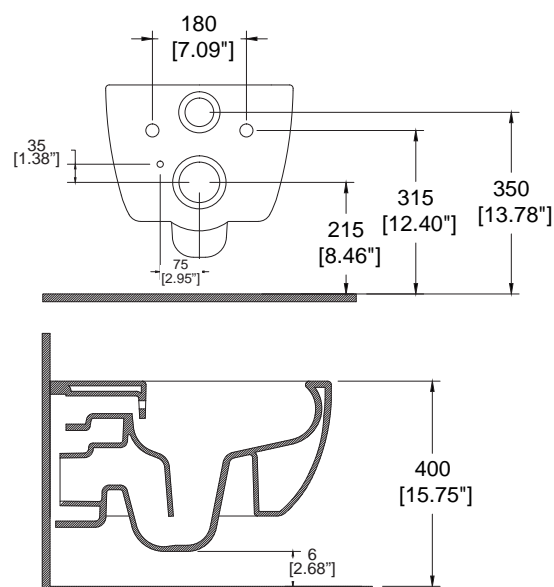
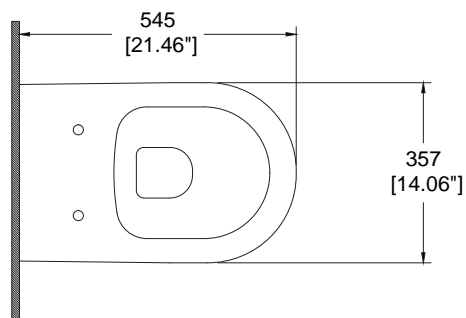



COMFORT & CARE

BOCCHI select Comfort & Care grab bars and shower seats add stability and care to the bathroom in a range of unique installations, colors and styles.

Grab bars are available in high gauge stainless steel, or a uniquely colored surface that offers a warm touch and antibacterial qualities.

Shower seats easily fold up and away to add function to even the smallest of shower spaces.



Warm Touch

Soft-Touch surfaces stay looking warm to the touch and resist the coolness of metal



Hygienic

Soft-Touch surfaces deter the growth of bacteria and mildew



Superior Grip

Soft-Touch surfaces provide a non-slip surface even when wet



No Rust/No Scratch

Soft-Touch surfaces resist scratching and rusting to stay looking like new



GRAB BARS

Made of seamless grade 304 stainless steel with hidden flange caps. Available in unique Soft-Touch finish and colors.



TBXX-XXX-1210 **Swing-Up Grab Bar w/ Locking** **Mechanism 29-1/2" 5-7/8"**

Features a locking mechanism to secure bar in the up position; White, Black and Orange colors feature unique Soft-Touch technology that stays warm to the touch

- TBST-001-1210 white
- TBST-005-1210 black
- TBST-012-1210 orange
- TBPC-101-1210 stainless steel





SHOWER SEATS

Easy to clean phenolic shower seats fold up and away to save space. Capable of supporting up to 440 pounds.



TBDO-101-XXXX
Phenolic Folding Shower Seat
17-3/4" x 17-1/2"

Phenolic material is easy to clean and water and mildew resistant; stainless steel framing with hidden flange caps; folds up to save space when needed; supports up to 440 lbs

 TBDO-101-1004 white

 TBDO-101-1005 oak

THANK YOU FOR CHOOSING BOCCHI

Thank you for choosing BOCCHI. By doing so, you will enjoy the outstanding quality and durability of your new BOCCHI product for many years to come.

All information in this guide is based upon the latest product information at the time of publication. At BOCCHI, we strive to fulfill our mission of improving the level of luxurious living for each person who is touched by our products and services. We reserve the right to make changes in product characteristics, packaging, or availability at any time without notice.

Please take a few minutes to review this guide. Pay special attention to the care and cleaning instructions.

Proof of purchase (original sales receipt) must be provided to BOCCHI with all warranty claims from a valid BOCCHI vendor. BOCCHI is not responsible for labor charges, installation, or other incidental or consequential costs. In no event shall the liability of BOCCHI exceed the purchase price of the product.

FIRECLAY, VITREOUS CHINA and GRANITE KITCHEN AND BATHROOM FIXTURES LIFETIME LIMITED WARRANTY

BOCCHI warrants its fireclay fixtures, sinks, vitreous china toilet bowls, and granite sinks to be free of defects in material and workmanship during normal residential use for as long as the original consumer purchaser owns their home. Gloss reduction, scratching, staining, and acid or alkaline etching of the finish over time due to use, cleaning practices or water or atmospheric conditions are normal wear and tear. This warranty applies only to BOCCHI fireclay fixtures, sinks, vitreous china toilet bowls and granite sinks installed in the United States of America or Canada (North America). If a defect is found in normal residential use, BOCCHI will, at its election, repair, replace or make appropriate adjustment. Damage caused by accident, misuse, or abuse, such as cracks, chips and scratches after installation, is not covered by this warranty. Improper care and cleaning will void the warranty. If the fireclay fixture, sink, vitreous china toilet bowl, or granite sink is used commercially, or is installed outside of North America, BOCCHI

warrants the product to be free from defects in material and workmanship for one (1) year from the date the product is installed, with all other terms of this warranty applying except duration. All other components other than the fireclay, vitreous china or granite carry BOCCHI's one-year limited warranty unless otherwise specified.

KITCHEN FAUCETS LIFETIME LIMITED WARRANTY

BOCCHI warrants all aspects of their faucets to be free of defects in material and workmanship during normal residential use for as long as the original consumer purchaser owns their home. This warranty applies only to BOCCHI faucets installed in North America. If a defect is found in normal residential use, BOCCHI will, at its election, repair, provide a replacement part or product, or make appropriate adjustment. Damage to a product caused by accident, misuse, or abuse is not covered by this warranty.*

If the faucet is used commercially, or is installed outside of North America, BOCCHI warrants the faucet to be free from defects in material and workmanship for one (1) year from the date the product is installed, under BOCCHI's standard one-year limited warranty.

KITCHEN SINK & FAUCET ACCESSORIES, GRAB BARS AND SHOWER SEATS ONE-YEAR LIMITED WARRANTY

BOCCHI warrants all aspects of the fixture, accessories such as cutting boards, colanders, drain covers, soap dispensers, grab bars, shower seats and other kitchen or bathroom accessories and workstation products ("Accessories") to be free of defects in material and workmanship during normal residential use for one year so long as the original consumer purchaser owns their home. This warranty applies only to BOCCHI Accessories installed in North America. If a defect is found in normal residential use, BOCCHI will, at its election, repair, provide a replacement part or product, or make appropriate adjustment. Damage to a product caused by accident, misuse, or abuse is not covered by this warranty. Improper care and cleaning will void the warranty.*

If the Accessory is used commercially, or is installed outside of North America, BOCCHI warrants the Accessory to be free from defects in material and workmanship for one (1) year from the date the product is installed, under BOCCHI standard one-year limited warranty.

--

*DO NOT USE cleaners containing abrasive cleansers, ammonia, bleach, acids, waxes, alcohol, solvents or other products not recommended for chrome or stainless steel. This will void the warranty. DO NOT use drain unblocking products that involve filling sinks with chemicals.

BATHROOM FURNITURE THREE-YEAR LIMITED WARRANTY

BOCCHI warrants all aspects of their furniture to be free of defects in material and workmanship during normal residential use for three (3) years so long as the original consumer purchaser owns their home. This warranty applies only to BOCCHI bathroom furniture installed in North America. If a defect is found in normal residential use, BOCCHI will, at its election, repair, provide a replacement part or product, or make appropriate adjustment. Damage to a product caused by accident, misuse, or abuse is not covered by this warranty. Improper care and cleaning will void the warranty.* If the furniture is used to commercially, or is installed outside of North America, BOCCHI warrants the Furniture to be free from defects in material and workmanship for three (3) years from the date the product is installed, under BOCCHI standard 3-year limited warranty.

BOCCHI AND/OR SELLER ARE PROVIDING THIS WARRANTY IN LIEU OF ALL OTHER WARRANTIES, EXPRESSED OR IMPLIED, INCLUDING BUT NOT LIMITED TO THE IMPLIED WARRANTIES OF MERCHANTABILITY AND FITNESS FOR A PARTICULAR PURPOSE. BOCCHI AND/OR SELLER DISCLAIM ANY LIABILITY FOR SPECIAL, INCIDENTAL OR CONSEQUENTIAL DAMAGES.

Some states/provinces do not allow limitations on how long an implied warranty lasts, or the exclusion or limitation of special, incidental or consequential damages, so these limitations and exclusions may not apply to you. This warranty gives you specific legal rights. You may also have other rights which vary from state/province to state/province. This warranty is to the original consumer purchaser only, and excludes product damage due to installation error, product abuse, or product misuse, whether performed by a contractor, service company, or consumer. This is BOCCHI's exclusive written warranty.

General Care and Cleaning Tips

For best results, keep the following in mind when caring for your product: Always test your cleaning solution on an inconspicuous area before applying it to the entire surface. Wipe surfaces clean and rinse completely with water immediately after applying cleanser. Rinse and dry any over-spray that lands on nearby surfaces. DO NOT allow cleansers to soak on surfaces. Use a soft, dampened sponge or cloth. NEVER use an abrasive material such as a harsh brush or scouring pad to clean any BOCCHI surface. Success with cleaners and procedures is dependent upon such factors as the hardness and temperature of the water, exact measurements of ingredients, changes in cleaning formulas and the condition of the product being cleaned. Since there are variations within these factors, BOCCHI cannot guarantee the effectiveness of the formulas mentioned.

Care & Cleaning Tips for Fireclay and Vitreous China: Rinse thoroughly and use a soft cloth to wipe the product dry after each use. Soft abrasive cleaners may be used when necessary to clean BOCCHI fireclay and vitreous china fixtures. Strong abrasive cleaners should NEVER be used and may scratch or dull the surface. The appearance of surface marks and build-up of rust or other stains, minerals, etc. on the surface may be easily removed using recommended cleansers such as Bar Keepers Friend.

Care & Cleaning Tips for Granite: Rinse thoroughly and use a soft cloth to wipe the product dry after each use. Soft abrasive cleaners may be used when necessary to clean, strong abrasive cleaners should NEVER be used. To prevent limescale build-up leave a solution of warm water and white vinegar or a specific descaling/anti-limescale product for use with granite sinks, on the sink bottom for a few hours (or as directed)--then rub vigorously with a non-abrasive sponge until clean and rinse and dry sink.

Care & Cleaning Tips for Faucets, Soap Dispensers, Chrome and Other Metal Surfaces: DO NOT use cleansers containing ammonia, bleach or acid. Rinse thoroughly and use a soft cloth to wipe the product dry after each use. The ideal cleaning technique is to always blot dry any water from metal surfaces. Allowing water to evaporate on metal will form water deposits. It is important to use a dabbing action to dry metal, NOT an abrasive or rubbing action. Cleaning with a damp sponge or cloth and buff drying should keep your product looking beautiful.

THANK YOU FOR CHOOSING BOCCHI

Care & Cleaning Tips for Sink Accessories: Non-wood accessories may be cleaned using standard dish soap, or be washed in a dishwasher. It is important to thoroughly dry after each wash to maintain the best finish to each surface. Wood accessories should be thoroughly washed and dried after each use and never stored wet to prevent warping. Occasional application of a thin coating of food-grade oil to the wood surfaces will prevent them from drying out. Be sure to wipe off any excess oil after application.

Care & Cleaning Tips for Bathroom Furniture: To maintain your bathroom furniture, use a soft, damp cloth for gentle cleaning. After cleaning the wood surfaces, ensure thorough drying. Opt for mild cleaning materials or soapy water, while avoiding abrasive and acidic cleaners: test on an unexposed area before using. Be careful to prevent contact extreme heats from styling tools etc. Avoid exposure to extreme temperatures and intense sunlight to prevent damage. Avoid moisture buildup to prolong the furniture's lifespan.

[See more cleaning & care tips on-line](#)

WWW.BOCCHIUSA.COM









BOCCHI[®]

6590 Shiloh Rd East, Ste D
Alpharetta, GA 30005

T. 877-565-2221
T. 678-878-3771

info@bocchiusa.com



www.bocchiusa.com

06.2024
USA